



Gotham Architectural Downlighting
International Compact Fluorescent Downlights/Wallwash

AFI/AFWI
20.3cm (8") Open/Wallwash

Horizontal DTT or TRT Lamp

FEATURES

OPTICAL SYSTEM

- Reflector: Self-flanged, semi-specular or matte-diffuse reflector. Fluted vertical upper section works in conjunction with Patented Bounding Ray™ Optical Principle design (U.S. Patent No. 5,800,050) to provide lamp before lamp image and smooth transition from top of reflector to bottom. Minimum flange matches reflector finish.
- Baffle/cone: Semi-specular clear upper reflector. Microgroove baffle with white painted flange or specular black cone with flange that matches cone finish.
- Hinged lampdoor provided for optimal fixture efficiency and the reduction of stray light in the plenum.
- Wallwash: Highly reflective outer kicker reflector provides smooth, uniform illumination floor to ceiling, edge to edge. Inner cone is contoured to eliminate room side flash. For optimal uniformity, the recommended luminaire spacing is 0.9m (3') from the wall and 0.9m (3') centers.

MECHANICAL SYSTEM

- Pre-wired galvanized steel junction box mounted to reflector is provided with removable access cover. No. 12 AWG conductors, rated for 90°C.

- Three (3) swinggate brackets allow for installation from below the ceiling. Suitable for ceiling thickness ranging from 1.59cm (5/8") to 2.54cm (1").

ELECTRICAL SYSTEM

- Horizontally-mounted, positive-latch, thermoplastic socket.
- Thermally protected, high power factor electronic ballast (50/60Hz) mounted to the junction box.
- Eurostyle terminal block included for power supply and ground connections required for CE.

LISTING

- MVOLT, 120V and 277V fixtures are UL Listed, Non-IC recessed mounting and damp locations. 220V and 240V fixtures are CE certified and rated IP20.

WARRANTY

- 1-year limited warranty. Complete warranty terms located at www.acuitybrands.com/CustomerResources/Terms_and_conditions.aspx

ORDERING INFORMATION

EXAMPLE: AFI 2/32TRT 8AR MVOLT

Series	Wattage/Lamp	Aperture/Trim color	Finish	Voltage	Ballast	Options				
AFI	1/13DTT	8AR	Clear	(blank)	Semi-specular	MVOLT ^{3,5}	(blank)	Electronic ballast	TRW	White painted flange
AFWI	1/18DTT	8PR	Pewter	LD	Matte-diffuse	120 ⁶	ECOS	Lutron® EcoSystem® electronic dimming ballast. Minimum dimming level 5%.	TRBL	Black painted flange
	1/26DTT	8WTR	Wheat			220 ⁴			WLP	With 3500 K lamp (shipped separately)
	1/13TRT	8CB ^{1,2}	Cross baffle			240 ⁴	ADEZ ⁵	Advance Mark 10® electronic dimming ballast. Minimum dimming level 5%	GMF	Single, slow-blow fuse
	1/18TRT	8BC ^{1,2}	Black cone			277 ⁵			GLR	Single, fast-blow fuse
	1/26TRT	8WR ^{1,2}	White painted				ADZT ⁶	Advance Mark 7® electronic 0-10V DC dimming ballast. Minimum dimming level 3%	GSKT	Foam gasketing, ships uninstalled
	1/32TRT						VDB ⁷	Vossloh 0-10V dimming ballast		
	1/42TRT									
	2/13TRT									
	2/18TRT									
	2/26TRT									
	2/32TRT									
	2/42TRT									

NOTES

ORDERING NOTES

1. AFI only.
2. Not available with finishes
3. Multi-volt electronic ballast capable of operating on any line voltage from 120V through 277V, 50 or 60 Hz.
4. Available with CE listing only. 220-240V, 50/ 60 Hz.
5. Available with UL listing only. 120-277V, 50/60Hz.
6. Available with 120V or 277V only.
7. Available with 220V or 240V only.

All dimensions are inches (centimeters) unless otherwise noted.

UL Listed

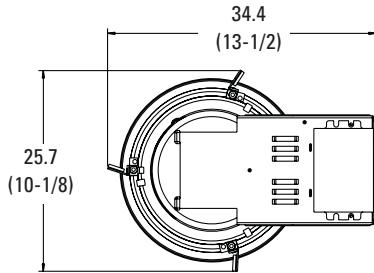

CE Certified

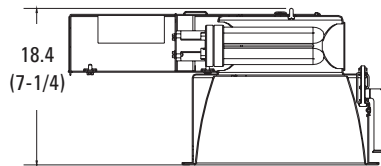
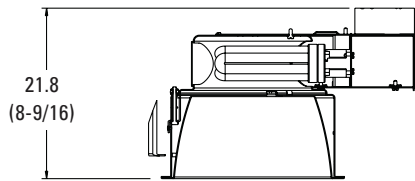
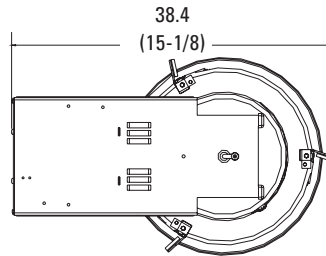

- Aperture: 20.1 (7-7/8)
- Ceiling Opening: 21.9 (8-5/8)
- Overlap Trim: 23.5 (9-1/4)

Distribution Curve Distribution Data Output Data Coefficient of Utilization Illuminance: Single Luminaire 30" Above Floor

AFI 1/32TRT 8AR (1) CF32DT/E/IN/835, 2400 LUMENS PER LAMP, 1.3 S/MH, TEST NO. LTL9452

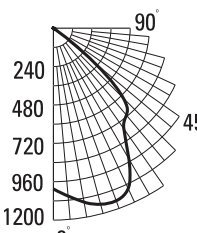

From 0°	cp.	Lumens	Zone	Lumens	%lamp	pf	pc	80%		20%		50%	50%	50%	50%	50%	50%	50%	50%
								pw	50%	30%	50%								
0°	1005		0°-30°	785.7	32.7	1	74	72	72	70	69	68							
5°	1053	95	0°-40°	1190.3	49.6	2	67	64	66	63	64	61							
15°	1140	275	0°-60°	1590.4	66.3	3	62	57	61	57	59	56							
25°	1105	416	0°-90°	1619.7	67.5	4	56	52	56	51	54	50							
35°	768	405	90°-180°	0.0	0.0	5	52	47	51	47	50	46							
45°	622	354	0°-180°	1619.7	67.5*	6	48	43	47	43	46	42							
55°	42	46				7	44	39	43	39	43	38							
65°	11	11				8	41	36	40	36	39	35							
75°	9	10				9	38	33	37	33	37	33							
85°	8	8				10	35	31	35	30	34	30							
90°	0	0																	

Mount height	Initial fc at beam center	50% beam angle 61.0°		10% beam angle 94.7°	
		Beam diameter	fc at beam edge	Beam diameter	fc at beam edge
8'	33.2	6.5	16.6	11.9	3.3
10'	17.9	8.8	8.9	16.3	1.8
12'	11.1	11.2	5.6	20.6	1.1
14'	7.6	13.5	3.8	25.0	0.8
16'	5.5	15.9	2.8	29.3	0.6

AFI 1/42TRT 8AR (1) CF42DT/E/IN/835, 3200 LUMENS PER LAMP, 1.3 S/MH, TEST NO. LTL9455

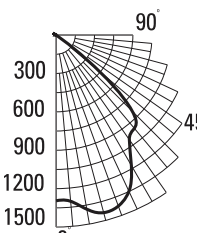

From 0°	cp.	Lumens	Zone	Lumens	%lamp	pf	pc	80%		20%		50%	50%	50%	50%	50%	50%	50%	
								pw	50%	30%	50%								70%
0°	1295		0°-30°	1083.2	33.8	1	74	72	73	71	70	69							
5°	1303	122	0°-40°	1653.4	51.7	2	68	65	67	64	65	62							
15°	1437	373	0°-60°	2166.3	67.7	3	62	59	61	58	60	57							
25°	1347	588	0°-90°	2171.7	67.9	4	57	53	56	52	55	51							
35°	998	570	90°-180°	0.0	0.0	5	53	48	52	48	51	47							
45°	848	464	0°-180°	2171.7	67.9*	6	49	44	48	43	47	43							
55°	42	49				7	45	40	44	40	43	39							
65°	4	4				8	41	37	41	37	40	36							
75°	1	1				9	38	34	38	34	37	33							
85°	0	0				10	36	31	36	31	35	31							
90°	0	0																	

Mount height	Initial fc at beam center	50% beam angle 64.5°		10% beam angle 94.8°	
		Beam diameter	fc at beam edge	Beam diameter	fc at beam edge
8'	42.8	6.9	21.4	12.0	4.3
10'	23.0	9.5	11.5	16.3	2.3
12'	14.3	12.0	7.2	20.7	1.4
14'	9.8	14.5	4.9	25.0	1.0
16'	7.1	17.0	3.6	19.3	0.7

AFI 2/32TRT 8AR (2) CF32DT/E/IN/835, 2400 LUMENS PER LAMP, 1.4 S/MH, TEST NO. LTL9407

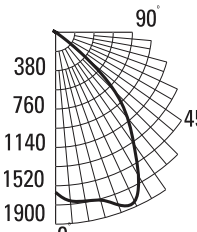

From 0°	cp.	Lumens	Zone	Lumens	%lamp	pf	pc	80%		20%		50%	50%	50%	50%	50%	50%	50%	
								pw	50%	30%	50%								70%
0°	1584		0°-30°	1473.7	30.7	1	66	65	65	64	63	61							
5°	1676	165	0°-40°	2288.7	47.7	2	61	58	60	57	58	56							
15°	1720	514	0°-60°	2901.1	60.4	3	56	52	55	52	53	51							
25°	1849	795	0°-90°	2909.7	60.6	4	51	48	51	47	49	46							
35°	1348	815	90°-180°	0.0	0.0	5	47	43	47	43	46	42							
45°	830	549	0°-180°	2909.7	60.6*	6	44	39	43	39	42	39							
55°	36	63				7	40	36	40	36	39	35							
65°	5	6				8	37	33	37	33	36	33							
75°	2	2				9	35	31	34	30	34	30							
85°	0	0				10	32	28	32	28	31	28							
90°	0	0																	

Mount height	Initial fc at beam center	50% beam angle 67.9°		10% beam angle 94.3°	
		Beam diameter	fc at beam edge	Beam diameter	fc at beam edge
8'	52.4	7.4	26.2	11.9	5.2
10'	28.2	10.1	14.1	16.2	2.8
12'	17.6	12.8	8.8	20.5	1.8
14'	12.0	15.5	6.0	24.8	1.2
16'	8.7	18.2	4.3	29.1	0.9

AFI 2/42TRT 8AR (2) CF42DT/E/IN/835, 3200 LUMENS PER LAMP, 1.4 S/MH, TEST NO. LTL9406

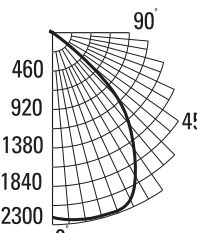

From 0°	cp.	Lumens	Zone	Lumens	%lamp	pf	pc	80%		20%		50%	50%	50%	50%	50%	50%	50%	
								pw	50%	30%	50%								70%
0°	2211		0°-30°	2029.5	31.7	1	69	67	67	66	65	64							
5°	2248	225	0°-40°	3166.3	49.5	2	63	60	62	59	60	58							
15°	2270	707	0°-60°	3999.6	62.5	3	58	54	57	54	55	52							
25°	2205	1097	0°-90°	4009.9	62.7	4	53	49	52	49	51	48							
35°	1699	1137	90°-180°	0.0	0.0	5	49	45	48	44	47	44							
45°	1092	749	0°-180°	4009.9	62.7*	6	45	41	45	40	44	40							
55°	47	84				7	42	37	41	37	40	37							
65°	7	8				8	39	34	38	34	37	34							
75°	3	3				9	36	32	36	31	35	31							
85°	0	0				10	33	29	33	29	33	29							
90°	0	0																	

Mount height	Initial fc at beam center	50% beam angle 67.6°		10% beam angle 94.1°	
		Beam diameter	fc at beam edge	Beam diameter	fc at beam edge
8'	73.1	7.4	36.5	11.8	7.3
10'	39.3	10.0	19.7	16.1	3.9
12'	24.5	12.7	12.2	20.4	2.4
14'	16.7	15.4	8.4	24.7	1.7
16'	12.1	18.1	6.1	29.0	1.2

PHOTOMETRY NOTES

- Tested to current IES and NEMA standards under stabilized laboratory conditions.
- Actual performance may differ as a result of end-user environment and application.
- Consult factory or IES file for microgroove baffle, black cone or other photometric reports.