



Gotham Architectural Downlighting  
International Compact Fluorescent Downlights/Wallwash

**AFVI/AFVWI**  
**15.2cm (6'') Open/Wallwash**

Vertical DTT or TRT Lamp

FEATURES

**OPTICAL SYSTEM**

- Reflector: Self-flanged, semi-specular or matte-diffuse reflector. Patented Vertisys® - Bounding Ray™ Optical Principle design (US Patent #5,800,050) provides lamp before lamp image. Lamp image that reflects smoothly from the top of the reflector to the aperture, providing optimal fixture performance and efficiency.
- Wallwash: Highly reflective outer kicker reflector provides smooth, uniform illumination floor to ceiling, edge to edge. Inner cone is contoured to eliminate room side flash. For optimal uniformity, the recommended luminaire spacing is 0.9m (3') from the wall and 0.9m (3') centers.

**MECHANICAL SYSTEM**

- Pre-wired galvanized steel junction box mounted to reflector is provided with removable access cover. Knockouts provided for power supply feed and conduit runs. No. 12 AWG conductors, rated for 90°C.
- Three (3) swinggate brackets allow for installation from below the ceiling. Suitable for ceiling thickness ranging from 1.59cm (5/8'') to 2.54cm (1'').

**ELECTRICAL SYSTEM**

- Rugged aluminum lampholder housing.
- Vertically-mounted, positive-latch, thermoplastic socket.
- Thermally protected, high power factor electronic ballast (50/60Hz) mounted to the junction box.
- Eurostyle terminal block included for power supply and ground connections required for CE.

**LISTING**

- MVOLT, 120V and 277V fixtures are UL Listed, Non-IC recessed mounting and damp locations. 220V and 240V fixtures are CE certified and rated IP20.

**WARRANTY**

- 1-year limited warranty. Complete warranty terms located at: [www.acuitybrands.com/CustomerResources/Terms\\_and\\_conditions.aspx](http://www.acuitybrands.com/CustomerResources/Terms_and_conditions.aspx)

ORDERING INFORMATION

**EXAMPLE: AFVI 32TRT 6AR 240**

Series	Wattage/Lamp	Aperture/Trim color	Finish	Voltage	Ballast	Options
AFVI	13DTT	6AR Clear	(blank) Semi-specular	MVOLT <sup>3,5</sup>	(blank) Electronic ballast	TRW White painted flange
AFVWI	18DTT	6PR Pewter	LD Matte-diffuse	120 <sup>6</sup>	ECOS Lutron® EcoSystem® electronic dimming ballast. Minimum dimming level 5%.	TRBL Black painted flange
	26DTT	6WTR Wheat		220 <sup>4</sup>	ADEZ <sup>5</sup> Advance Mark 10® electronic dimming ballast. Minimum dimming level 5%	WLP With 3500 K lamp (shipped separately)
	13TRT	6WR <sup>1,2</sup> White painted		240 <sup>4</sup>	ADZT <sup>5</sup> Advance Mark 7® electronic 0-10V DC dimming ballast. Minimum dimming level 3%	GMF Single, slow-blow fuse
	18TRT			277 <sup>5</sup>	VDB <sup>7</sup> Vossloh 0-10V dimming ballast	GLR Single, fast-blow fuse
	26TRT					GSKT Foam gasketing, ships uninstalled
	32TRT					
	42TRT					

NOTES

**ORDERING NOTES**

1. Not available with finishes.
2. AFVI only.
3. Multi-volt electronic ballast capable of operating on any line voltage from 120V through 277V, 50 or 60 Hz.
4. Available with CE listing only. 220-240V, 50/ 60 Hz.
5. Available with UL listing only. 120-277V, 50/60Hz.
6. Available with 120V or 277V only.
7. Available with 220V or 240V only.

DIMENSIONAL DATA

All dimensions are inches (centimeters) unless otherwise noted.

**UL Listed**

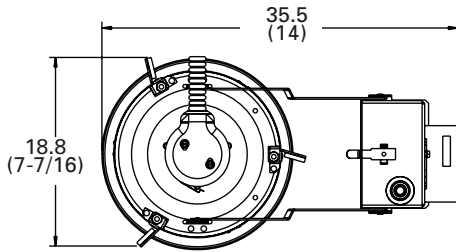

**CE Certified**

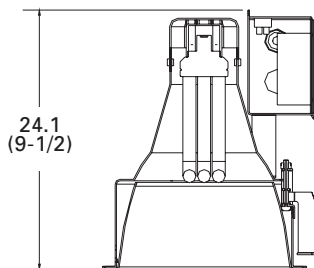
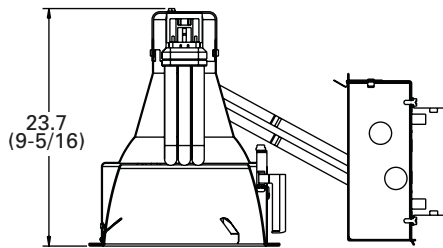
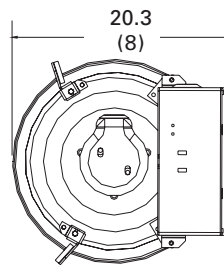

- Aperture: 15.9 (6-1/4)
- Ceiling opening: 17.5 (6-7/8)
- Overlap trim: 19.1 (7-1/2)

Distribution Curve      Distribution Data      Output Data      Coefficient of Utilization      Illuminance: Single Luminaire 30" Above Floor

**AFVI 26TRT 6AR**      (1) PL-T 26W/30/4P LAMP, 1800 RATED LUMENS, 1.2 S/MH, TEST NO. 94021501

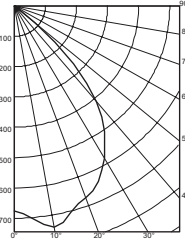

From 0°	Ave Lumens	Zone Lumens	%lamp	pf	80%		20%		50%		Mount height	Initial fc at beam center	50% beam angle 63.7°		10% beam angle 93.3°		
					pc	pw	50%	30%	50%	30%			50%	30%	Beam diameter	fc at beam edge	Beam diameter
0°	676	0°-30°	559.4	31.1	1	66	65	65	63	62	61	8'	22.3	6.8'	11.2	11.7'	2.2
5°	706	0°-40°	871.9	48.4	2	61	58	60	57	58	56	10'	12.0	9.3'	6.0	15.9'	1.2
15°	704	0°-60°	1085.5	60.3	3	56	53	55	52	53	51	12'	7.5	11.8'	3.7	20.1'	0.7
25°	639	0°-90°	1085.7	60.3	4	51	48	51	47	49	46	14'	5.1	14.3'	2.6	24.4'	0.5
35°	505	90°-180°	0	0.0	5	47	43	47	43	46	42	16'	3.7	16.8'	1.9	28.6'	0.4
45°	269	0°-180°	1085.7	60.3*	6	44	40	43	39	42	39						
55°	4				7	41	36	40	36	39	36						
65°	0				8	38	34	37	33	37	33						
75°	0				9	35	31	35	31	34	31						
85°	0				10	33	29	32	29	32	28						
90°	0																

**AFVI 32TRT 6AR**      (1) PL-T 32W/30/4P LAMP, 2400 RATED LUMENS, 1.1 S/MH, TEST NO. 17111

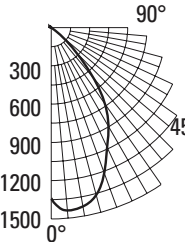

From 0°	Ave Lumens	Zone Lumens	%lamp	pf	80%		20%		50%		Mount height	Initial fc at beam center	50% beam angle 54.6°		10% beam angle 89.4°		
					pc	pw	50%	30%	50%	30%			50%	30%	Beam diameter	fc at beam edge	Beam diameter
0°	1146	0°-30°	787.2	54.7	1	66	64	65	63	62	61	8'	37.9	5.7'	18.9	10.9'	3.8
5°	1150	0°-40°	1177.5	49.1	2	61	58	60	57	58	56	10'	20.4	7.7'	10.2	14.8'	2.0
15°	1012	0°-60°	1430.1	59.6	3	56	53	55	52	53	51	12'	12.7	9.8'	6.4	18.8'	1.3
25°	861	0°-90°	1438.3	59.9	4	52	48	51	47	49	47	14'	8.7	11.9'	4.3	22.8'	0.9
35°	631	90°-180°	0	0.0	5	48	44	47	43	46	43	16'	6.3	13.9'	3.1	26.7'	0.6
45°	308	0°-180°	1438.3	59.9*	6	44	40	44	40	43	39						
55°	20				7	41	37	41	37	40	36						
65°	6				8	38	34	38	34	37	34						
75°	2				9	36	32	35	32	35	31						
85°	0				10	33	29	33	29	33	29						
90°	0																

**AFVI 32TRT 6MB**      (1) PL-T 32W/30/4P LAMP, 2400 RATED LUMENS, 1.0 S/MH, TEST NO. 2196071001

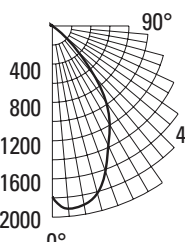

From 0°	cp.	Lumens	Zone Lumens	%lamp	pf	80%		20%		50%		Mount height	Initial fc at beam center	50% beam angle 53.7°		10% beam angle 85.6°	
						pc	pw	50%	30%	50%	30%			50%	30%	Beam diameter	fc at beam edge
0°	1568	0°-30°	1097	34.3	1	63	61	61	60	59	58	8'	51.8	5.6'	25.9	10.2'	5.2
5°	1705	0°-40°	1602	50.1	2	58	55	57	55	55	53	10'	27.9	7.6'	13.9	13.9'	2.8
15°	1467	0°-60°	1808	56.5	3	54	51	53	50	51	49	12'	17.4	9.6'	8.7	17.6'	1.7
25°	1145	0°-90°	1817	56.8	4	50	46	49	46	48	45	14'	11.9	11.7'	5.9	21.3'	1.2
35°	821	90°-180°	0	0.0	5	46	43	46	42	45	42	16'	8.6	13.7	4.3	25.0'	0.9
45°	244	0°-180°	1817	56.8*	6	43	40	43	39	42	39						
55°	10				7	40	37	40	36	39	36						
65°	4				8	38	34	37	34	37	34						
75°	2				9	35	32	35	32	34	31						
85°	2				10	33	30	33	30	32	29						
90°	0																

**PHOTOMETRY NOTES**

- Tested to current IES and NEMA standards under stabilized laboratory conditions.
- Actual performance may differ as a result of end-user environment and application.
- Consult factory or IES file for microgroove baffle, black cone or other photometric reports.