



Gotham Architectural Downlighting
International Compact Fluorescent Downlights/Wallwash

AFVI/AFVWI
20.3cm (8") Open/Wallwash

Vertical DTT or TRT Lamp

FEATURES

OPTICAL SYSTEM

- Self-flanged, semi-specular or matte-diffuse reflector. Patented Vertisys® - Bounding Ray™ Optical Principle design (US Patent #5,800,050) provides lamp before lamp image. Lamp image that reflects smoothly from the top of the reflector to the aperture, providing optimal fixture performance and efficiency.
- Wallwash: Highly reflective outer kicker reflector provides smooth, uniform illumination floor to ceiling, edge to edge. Inner cone is contoured to eliminate room side flash. For optimal uniformity, the recommended luminaire spacing is 0.9m (3') from the wall and 0.9m (3') centers.

MECHANICAL SYSTEM

- Pre-wired galvanized steel junction box mounted to reflector is provided with removable access cover. Knockouts provided for power supply feed and conduit runs. No. 12 AWG conductors, rated for 90°C.
- Three (3) swinggate brackets allow for installation from below the ceiling. Suitable for ceiling thickness ranging from 1.59cm (5/8") to 2.54cm (1").

ELECTRICAL SYSTEM

- Rugged aluminum lampholder housing.
- Vertically-mounted, positive-latch, thermoplastic socket.
- Thermally protected, high power factor electronic ballast (50/60Hz) mounted to the junction box.
- Eurostyle terminal block included for power supply and ground connections required for CE.

LISTING

- MVOLT, 120V and 277V fixtures are UL Listed, Non-IC recessed mounting and damp locations. 220V and 240V fixtures are CE certified and rated IP20.

WARRANTY

- 1-year limited warranty. Complete warranty terms located at: www.acuitybrands.com/CustomerResources/Terms_and_conditions.aspx

ORDERING INFORMATION

EXAMPLE: AFVI 32TRT 8AR 220

Series	Wattage/Lamp	Aperture/Trim color	Finish	Voltage	Ballast	Options
AFVI	13DTT	8AR Clear	(blank) Semi-specular	MVOLT ^{3,5}	(blank) Electronic ballast	TRW White painted flange
AFVWI	18DTT	8PR Pewter	LD Matte-diffuse	120 ⁶	ECOS Lutron® EcoSystem® electronic dimming ballast. Minimum dimming level 5%.	TRBL Black painted flange
	26DTT	8WTR Wheat		220 ⁴	ADEZ ⁵ Advance Mark 10® electronic dimming ballast. Minimum dimming level 5%	WLP With 3500 K lamp (shipped separately)
	13TRT	8WR ^{1,2} White painted		240 ⁴	ADZT ⁵ Advance Mark 7® electronic 0-10V DC dimming ballast. Minimum dimming level 3%	GMF Single, slow-blow fuse
	18TRT			277 ⁵	VDB ⁷ Vossloh 0-10V dimming ballast	GLR Single, fast-blow fuse
	26TRT					GSKT Foam gasketing, ships uninstalled
	32TRT					
	42TRT					

NOTES

ORDERING NOTES

- | | |
|--|---|
| 1. Not available with finishes. | 5. Available with UL listing only. 120-277V, 50/60Hz. |
| 2. AFVI only. | 6. Available with 120V or 277V only. |
| 3. Multi-volt electronic ballast capable of operating on any line voltage from 120V through 277V, 50 or 60 Hz. | 7. Available with 220V or 240V only. |
| 4. Available with CE listing only. 220-240V, 50/ 60 Hz. | |

DIMENSIONAL DATA

All dimensions are inches (centimeters) unless otherwise noted.

UL Listed

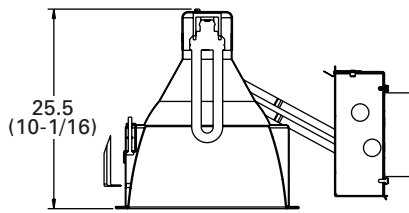
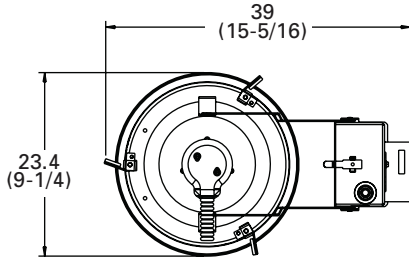

Aperture: 20 (7-7/8)
 Ceiling opening: 21.9 (8-5/8)
 Overlap trim: 23.5 (9-1/4)

CE Certified

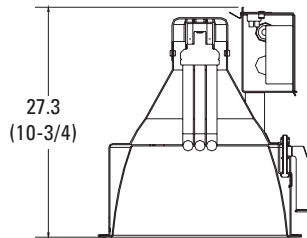
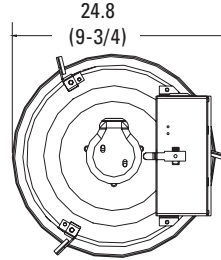

Distribution Curve Distribution Data Output Data Coefficient of Utilization Illuminance: Single Luminaire 30" Above Floor

AFVI 26TRT 8AR

(1) PL-T 26W/30/4P LAMP, 1800 RATED LUMENS, 1.3 S/MH, TEST NO. 2194021601

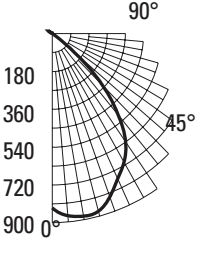

From 0°	cp.	Lumens	Zone	Lumens	%lamp	pf	80%		20%		50%	50%	50%	Mount height	Initial fc at beam center	50% beam angle 64.0°		10% beam angle 93.8°	
							pc	pw	50%	30%						50%	30%	50%	30%
0°	830		0°-30°	682	37.9														
5°	870	84	0°-40°	1071	59.5	1	83	81	82	80	78	77	8'	27.5	6.9'	13.7	11.8'	2.7	
15°	876	247	0°-60°	1349	75.0	2	78	75	76	74	74	72	10'	14.8	9.4'	7.4	16.0'	1.5	
25°	762	353	0°-90°	1349	75.0	3	72	68	71	68	69	66	12'	9.2	11.9'	4.6	20.3'	0.9	
35°	630	390	90°-180°	0	0.0	4	67	63	66	63	65	62	14'	6.3	14.4'	3.1	24.6'	0.6	
45°	354	255	0°-180°	1349	75.0*	5	63	58	62	58	60	57	16'	4.6	16.9'	2.3	28.9'	0.5	
55°	5	24				6	58	54	58	53	56	53							
65°	0	1			*Efficiency	7	54	49	53	49	52	48							
75°	0	1				8	50	45	49	45	48	44							
85°	0	1				9	46	41	45	43	45	40							
90°	0	0				10	42	37	42	37	41	37							

AFVI 32TRT 8AR

(1) PL-T 32W/30/4P LAMP, 2400 RATED LUMENS, 1.1 S/MH, TEST NO. 2194021402

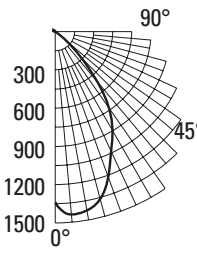

From 0°	cp.	Lumens	Zone	Lumens	%lamp	pf	80%		20%		50%	50%	Mount height	Initial fc at beam center	50% beam angle 55.3°		10% beam angle 87.6°	
							pc	pw	50%	30%					50%	30%	50%	30%
0°	1344		0°-30°	998	41.6													
5°	1440	137	0°-40°	1457	60.7	1	78	77	77	75	74	73	8'	44.5	5.8'	22.2	10.5'	4.4
15°	1360	382	0°-60°	1682	70.1	2	73	71	72	70	70	68	10'	23.9	7.9'	12.0	14.4'	2.4
25°	1036	481	0°-90°	1683	70.1	3	69	66	68	65	66	64	12'	14.9	9.9'	7.4	18.2'	1.5
35°	737	460	90°-180°	0	0.0	4	65	61	64	61	63	60	14'	10.2	12.0'	5.1	22.1'	1.0
45°	280	219	0°-180°	1683	70.1*	5	61	57	60	56	59	56	16'	7.4	14.1'	3.7	25.9'	0.7
55°	4	7			*Efficiency	6	57	53	57	53	55	52						
65°	1	1				7	53	49	53	49	52	49						
75°	0	1				8	50	46	49	46	49	45						
85°	0	1				9	47	43	46	42	46	42						
90°	0	0				10	43	39	43	39	43	39						

AFVI 32TRT 8AR

(1) PL-T 42W/30/4P LAMP, 3200 RATED LUMENS, 1.0 S/MH, TEST NO. 2195121902

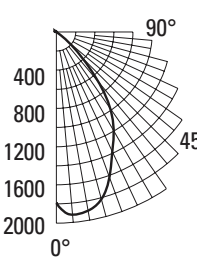

From 0°	cp.	Lumens	Zone	Lumens	%lamp	pf	80%		20%		50%	50%	Mount height	Initial fc at beam center	50% beam angle 53.7°		10% beam angle 85.6°	
							pc	pw	50%	30%					50%	30%	50%	30%
0°	1568		0°-30°	1097	34.3													
5°	1705	162	0°-40°	1602	50.1	1	63	61	61	60	59	58	8'	51.8	5.6'	25.9	10.2'	5.2
15°	1467	407	0°-60°	1808	56.5	2	58	55	57	55	55	53	10'	27.9	7.6'	13.9	13.9'	2.8
25°	1145	527	0°-90°	1817	56.8	3	54	51	53	50	51	49	12'	17.4	9.6'	8.7	17.6'	1.7
35°	821	505	90°-180°	0	0.0	4	50	46	49	46	48	45	14'	11.9	11.7'	5.9	21.3'	1.2
45°	244	198	0°-180°	1817	56.8*	5	46	43	46	42	45	42	16'	8.6	13.7	4.3	25.0'	0.9
55°	10	8			*Efficiency	6	43	40	43	39	42	39						
65°	4	4				7	40	37	40	36	39	36						
75°	2	3				8	38	34	37	34	37	34						
85°	2	2				9	35	32	35	32	34	31						
90°	0	0				10	33	30	33	30	32	29						

AFVI 32TRT 8MB

(1) PL-T 32W/30/4P LAMP, 2400 RATED LUMENS, 1.0 S/MH, TEST NO. 2196071102

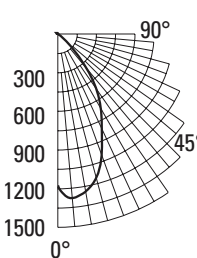

From 0°	cp.	Lumens	Zone	Lumens	%lamp	pf	80%		20%		50%	50%	Mount height	Initial fc at beam center	50% beam angle 50.8°		10% beam angle 84.2°	
							pc	pw	50%	30%					50%	30%	50%	30%
0°	1182		0°-30°	819	34.1													
5°	1279	120	0°-40°	1147	47.8	1	60	59	59	58	57	56	8'	39.1	5.2'	19.5	9.9'	3.9
15°	1157	322	0°-60°	1291	53.8	2	57	55	56	54	54	53	10'	21.0	7.1'	10.5	13.6'	2.1
25°	812	378	0°-90°	1291	53.8	3	53	51	53	50	51	49	12'	13.1	9.0'	6.6	17.2'	1.3
35°	525	329	90°-180°	0	0.0	4	50	48	50	47	49	47	14'	8.9	10.9'	4.5	20.8'	0.9
45°	176	141	0°-180°	1291	53.8*	5	47	44	47	44	46	44	16'	6.5	12.8'	3.2	24.4'	0.6
55°	2	4			*Efficiency	6	45	42	44	42	44	41						
65°	0	1				7	42	39	42	39	41	38						
75°	0	1				8	39	37	39	36	39	36						
85°	0	1				9	37	34	37	34	36	34						
90°	0	0				10	35	32	35	32	34	31						

PHOTOMETRY NOTES

- Tested to current IES and NEMA standards under stabilized laboratory conditions.
- Actual performance may differ as a result of end-user environment and application.
- Consult factory or IES file for microgroove baffle, black cone or other photometric reports.