



Gotham Architectural Downlighting
International Compact Fluorescent Downlights

LGFVI
15.2cm (6") Round Lens

Wet Location
Vertical DTT or TRT Lamp

FEATURES

OPTICAL SYSTEM

- Aluminum upper reflector coated with highly reflective white paint provides high efficiency and an evenly illuminated aperture appearance.
- Available with tempered prismatic lens (T73), flat fresnel lens (FFL) or flat opal lens (FOL).
- Regressed white door (RW) or stepped black baffle (SB) are available with white painted flange provided.
- Door is retained by self-aligning, torsion support springs, preventing gaps between door and ceiling.

MECHANICAL SYSTEM

- Pre-wired galvanized steel junction box mounted to reflector is provided with removable access cover. No. 12 AWG conductors rated for 90°C.
- Three (3) swinggate brackets allow for installation from below the ceiling. Suitable for ceiling thickness ranging from 1.59cm (5/8") to 2.54cm (1").

ELECTRICAL SYSTEM

- Rugged aluminum lampholder housing.
- Vertically-mounted, four-pin, positive-latch, thermoplastic socket.

- Thermally protected, high power factor electronic ballast (50/60Hz) mounted to the junction box.
- Eurostyle terminal block included for power supply and ground connections required for CE.

LISTING

- MVOLT, 120V and 277V fixtures are UL Listed, non-IC recessed mounting and wet locations. 220V and 240V fixtures are CE certified and rated IP44.

WARRANTY

- 1-year limited warranty. Complete warranty terms located at www.acuitybrands.com/CustomerResources/Terms_and_conditions.aspx

ORDERING INFORMATION

EXAMPLE: LGFVI 26TRT 6RW T73 220

Series	Wattage/Lamp	Aperture/Trim color	Lens type	Voltage	Ballast	Options	
LGFVI	13DTT	6RW	T73 Tempered prismatic lens FFL Flat fresnel lens FOL Flat opal lens PPC Prismatic polycarbonate lens	MVOLT ^{1,2} 120 ² 220 ³ 240 ³ 277 ²	(blank)	TRDA Tamper-resistant door assembly WLP With 3500 K lamp (shipped separately) GSKT Foam gasketing, ships uninstalled	
	18DTT				Electronic ballast		
	26DTT	Lutron EcoSystem® electronic dimming ballast. Minimum dimming level 5%.					
	13TRT	6SB			ADEZ ⁴		Advance Mark 10® electronic dimming ballast. Minimum dimming level 5%
	18TRT				ADZT ⁴		Advance Mark 7® electronic 0-10V DC dimming ballast. Minimum dimming level 3%
	26TRT	6RA			VDB ⁵		Vossloh 0-10V dimming ballast
	32TRT						
	42TRT						

NOTES

ORDERING NOTES

1. Multi-volt electronic ballast capable of operating on any line voltage from 120V through 277V, 50 or 60 Hz.
2. Available with UL listing only. 120-277V, 50/60Hz.
3. Available with CE listing only. 220-240V, 50/ 60 Hz.
4. Available with 120V or 277V only.
5. Available with 220V or 240V only.

DIMENSIONAL DATA

All dimensions are inches (centimeters) unless otherwise noted.

UL Listed

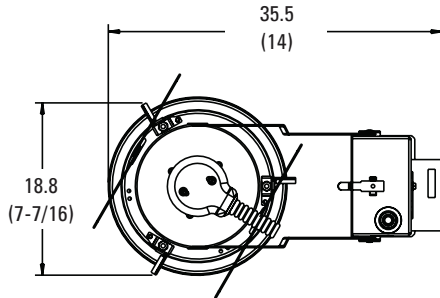

CE Certified

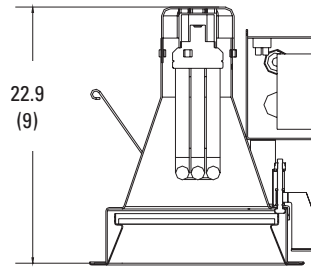
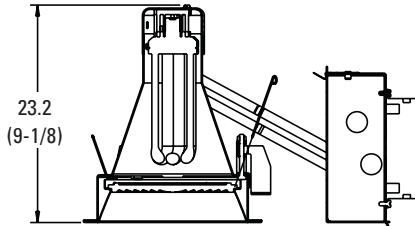
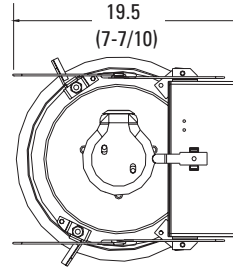

- Aperture: 15.9 (6-1/4)
- Ceiling Opening: 16.8 (6-5/8)
- Overlap Trim: 19.1 (7-1/2)

Distribution Curve Distribution Data Output Data Coefficient of Utilization Illuminance: Single Luminaire 30" Above Floor

LGFVI 32TRT 6RW T73

32TRT LAMP, 1.1 S/MH, 2400 RATED LUMENS, TEST NO. LTL14208

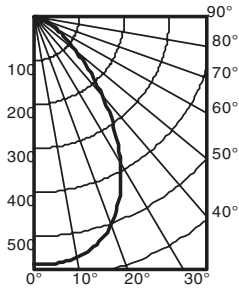

From 0°	Ave	Lumens	Zone	Lumens	% Lamp	pf	20%				50% beam angle		10% beam angle					
							80%		70%		56.1°		91.2°					
0° - 30°	5	563	0° - 30°	408.5	17.0	pc	50%	30%	50%	30%	50%	30%	Initial fc	fc at				
0° - 40°	15	536	0° - 40°	600.8	25.0	pw	50%	30%	50%	30%	50%	30%	Mount at beam height	at beam center	Beam diameter	beam edge	Beam diameter	fc at beam edge
0° - 60°	25	449	0° - 60°	810.1	33.8	1	.39	.38	.39	.37	.37	.36	8	18.6	5.9	9.3	11.2	1.9
0° - 90°	35	309	0° - 90°	873.8	36.4	2	.36	.34	.35	.33	.34	.32	10	10.0	8.0	5.0	15.3	1.0
90° - 180°	45	171	90° - 180°	0.0	0.0	3	.32	.30	.32	.30	.31	.29	12	6.2	10.1	3.1	19.4	0.6
0° - 180°	55	83	0° - 180°	873.8	*36.4	4	.29	.27	.29	.27	.28	.26	14	4.3	12.3	2.1	23.5	0.4
	65	41				5	.27	.24	.26	.24	.26	.24	16	3.1	14.4	1.5	27.6	0.3
	75	16				6	.25	.22	.24	.22	.24	.21						
	85	4				7	.23	.20	.23	.20	.22	.20						
	90	0				8	.21	.18	.21	.18	.20	.18						
						9	.20	.17	.19	.17	.19	.17						
						10	.18	.16	.18	.16	.18	.16						

LGFVI 32TRT 6RW FFL

32TRT LAMP, 1.1 S/MH, 2400 RATED LUMENS, TEST NO. LTL14209

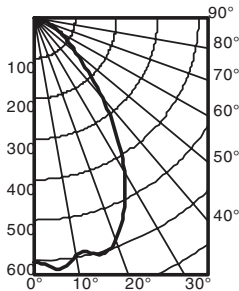

From 0°	Ave	Lumens	Zone	Lumens	% Lamp	pf	20%				50% beam angle		10% beam angle					
							80%		70%		58.1°		91.3°					
0° - 30°	5	604	0° - 30°	463.7	19.3	pc	50%	30%	50%	30%	50%	30%	Initial fc	fc at				
0° - 40°	15	624	0° - 40°	679.7	28.3	pw	50%	30%	50%	30%	50%	30%	Mount at beam height	at beam center	Beam diameter	beam edge	Beam diameter	fc at beam edge
0° - 60°	25	517	0° - 60°	914.0	38.1	1	.45	.43	.44	.43	.42	.41	8	20.0	6.1	10.0	11.3	2.0
0° - 90°	35	348	0° - 90°	995.1	41.5	2	.40	.38	.40	.38	.38	.37	10	10.7	8.3	5.4	15.3	1.1
90° - 180°	45	184	90° - 180°	0.0	0.0	3	.37	.34	.36	.33	.35	.33	12	6.7	10.6	3.3	19.4	0.7
0° - 180°	55	99	0° - 180°	995.1	*41.5	4	.33	.30	.33	.30	.32	.29	14	4.6	12.8	2.3	23.5	0.5
	65	54				5	.30	.27	.30	.27	.29	.27	16	3.3	15.0	1.7	27.6	0.3
	75	21				6	.28	.25	.28	.25	.27	.24						
	85	4				7	.26	.23	.25	.23	.25	.22						
	90	0				8	.24	.21	.24	.21	.23	.20						
						9	.22	.19	.22	.19	.22	.19						
						10	.21	.18	.21	.18	.20	.18						

PHOTOMETRY NOTES

- Tested to current IES and NEMA standards under stabilized laboratory conditions.
- Actual performance may differ as a result of end-user environment and application.
- Consult factory or IES file for microgroove baffle, black cone or other photometric reports.