



Gotham Architectural Downlighting
Renovation HID Downlights

6" LGHI
Round Lens

Wet Location
Vertical Metal Halide Lamp

FEATURES

OPTICAL SYSTEM

- Aluminum upper reflector coated with highly reflective white paint provides high efficiency and an evenly illuminated aperture appearance.
- Available with tempered prismatic lens (T73), flat fresnel lens (FFL) or flat opal lens (FOL).
- Regressed white door (RW) or stepped black baffle (SB) are available with white painted flange provided.
- Door is retained by self-aligning, torsion support springs, preventing gaps between door and ceiling.

MECHANICAL SYSTEM

- Galvanized steel junction box is mounted to reflector with hinge mechanism. Knockouts provided for power supply feed. No. 12 AWG conductors, rated for 90°C.
- Three (3) swinggate brackets allow for installation from below the ceiling. Suitable for ceiling thickness ranging from 5/8" (1.59cm) to 1" (2.54cm).

ELECTRICAL SYSTEM

- Die-cast aluminum lampholder housing.

- Medium-base porcelain socket with nickelplated screw shell.
- Thermally protected, high power factor electronic ballast (50/60Hz) mounted to the junction box.
- Thermally activated insulation detector.

LISTING

- Fixtures are UL Listed, non-IC recessed mounting and wet locations.

WARRANTY

- 1-year limited warranty. Complete warranty terms located at www.acuitybrands.com/CustomerResources/Terms_and_conditions.aspx

ORDERING INFORMATION

EXAMPLE: LGHI 100MHC 6RW T73 120

Series	Wattage/Lamp ¹	Aperture/Trim color	Lens type	Voltage	Options
LGHI	<u>Color-Corrected Metal Halide</u>	6RW Regressed white door	T73 Tempered prismatic lens	120 277	TRDA Tamper-resistant door assembly SF Single fuse WLP Lamp (shipped separately) GSKT Foam gasketing, ships uninstalled
	70MHC	6SB Stepped black baffle	FFL Flat fresnel lens		
	100MHC	6RA Regressed anodized	FOL Flat opal lens		

NOTES

ORDERING NOTES
1. Recommended for use with coated lamps.

6" LGHI
Round Lens

Wet Location, Vertical Metal Halide Lamp



DIMENSIONAL DATA

All dimensions are inches (centimeters) unless otherwise noted.

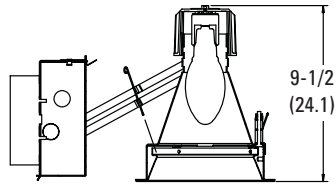
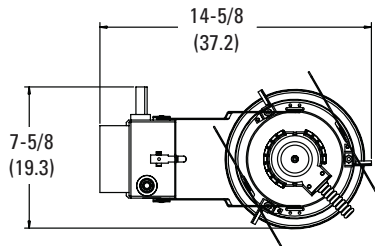

Aperture:	6-1/4 (15.9)
Ceiling Opening:	6-5/8 (16.8)
Overlap Trim:	7-1/2 (19.1)

Distribution Curve Distribution Data Output Data Coefficient of Utilization Illuminance: Single Luminaire 30" Above Floor

LGHI 100M 6RW T73

100W ED17 LAMP, 1.0 S/MH, 7900 RATED LUMENS, TEST NO. LTL14194

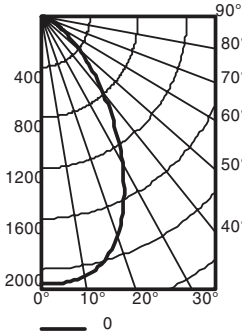

From 0°	Ave	Lumens	Zone	Lumens	% Lamp
0	2108		0° - 30°	1494.2	18.9
5	2114	201	0° - 40°	2153.5	27.3
15	1999	559	0° - 60°	2862.4	36.2
25	1611	734	0° - 90°	3075.6	38.9
35	1056	659	90° - 180°	0.0	0.0
45	579	451	0° - 180°	3075.6	*38.9
55	282	258	*E efficiency		
65	140	140			
75	52	59			
85	12	14			
90	0				

pf	20%						50% beam angle			10% beam angle		
	80%		70%		50%		54.3°			89.5°		
pc	50%	30%	50%	30%	50%	30%	Initial fc	fc at	fc at	fc at	fc at	
pw	50%	30%	50%	30%	50%	30%	Mount height	at beam center	Beam diameter	beam edge	Beam diameter	beam edge
1	.42	.41	.41	.40	.40	.39	8	69.7	5.6	34.8	10.9	7.0
2	.38	.36	.37	.36	.36	.35	10	37.5	7.7	18.7	14.9	3.7
3	.35	.32	.34	.32	.33	.31	12	23.4	9.7	11.7	18.8	2.3
4	.32	.29	.31	.29	.30	.28	14	15.9	11.8	8.0	22.8	1.6
5	.29	.26	.29	.26	.28	.26	16	11.6	13.8	5.8	26.8	1.2
6	.27	.24	.26	.24	.26	.23						
7	.25	.22	.24	.22	.24	.21						
8	.23	.20	.23	.20	.22	.20						
9	.21	.19	.21	.18	.21	.18						
10	.20	.17	.20	.17	.19	.17						

LGHI 100M 6RW FFL

100M ED17 LAMP, 1.1 S/MH, 7900 RATED LUMENS, TEST NO. LTL14195

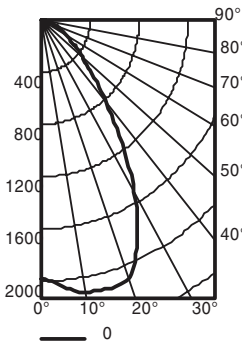

From 0°	Ave	Lumens	Zone	Lumens	% Lamp
0	1980		0° - 30°	1643.0	20.8
5	2045	198	0° - 40°	2362.3	29.9
15	2129	602	0° - 60°	3121.3	39.5
25	1858	843	0° - 90°	3385.3	42.9
35	1149	719	90° - 180°	0.0	0.0
45	592	466	0° - 180°	3385.3	*42.9
55	323	293	*E efficiency		
65	179	177			
75	66	71			
85	14	16			
90	0				

pf	20%						50% beam angle			10% beam angle		
	80%		70%		50%		60.0°			91.0°		
pc	50%	30%	50%	30%	50%	30%	Initial fc	fc at	fc at	fc at	fc at	
pw	50%	30%	50%	30%	50%	30%	Mount height	at beam center	Beam diameter	beam edge	Beam diameter	beam edge
1	.46	.45	.45	.44	.44	.43	8	65.5	6.4	32.7	11.2	6.5
2	.42	.40	.41	.39	.40	.38	10	35.2	8.7	17.6	15.3	3.5
3	.38	.35	.37	.35	.36	.34	12	21.9	11.0	11.0	19.3	2.2
4	.35	.32	.34	.31	.33	.31	14	15.0	13.3	7.5	23.4	1.5
5	.32	.29	.31	.28	.30	.28	16	10.9	15.6	5.4	27.5	1.1
6	.29	.26	.29	.26	.28	.25						
7	.27	.24	.27	.24	.26	.23						
8	.25	.22	.25	.22	.24	.21						
9	.23	.20	.23	.20	.23	.20						
10	.22	.19	.21	.19	.21	.18						

PHOTOMETRY NOTES

- Tested to current IES and NEMA standards under stabilized laboratory conditions.
- Actual performance may differ as a result of end-user environment and application.
- Consult factory or IES file for microgroove baffle, black cone or other photometric reports.