



Gotham Architectural Downlighting
Renovation HID Downlights/Wallwash

8" AH/AHWI
Open/Wallwash Reflector

Metal Halide Lamp

FEATURES

OPTICAL SYSTEM

- Self-flanged, semi-specular or matte-diffuse reflector. Patented Bounding Ray™ Optical Principle design (U.S. Patent No. 5,800,050).
- Outer kicker reflector provides smooth, uniform illumination ceiling to floor. For optimal uniformity, the recommended luminaire spacing is 3' from the wall and 3' centers.

MECHANICAL SYSTEM

- Galvanized steel junction box is mounted to reflector with hinge mechanism. Knockouts provided for power supply feed. No. 12 AWG conductors, rated for 90°C.
- Three (3) swinggate brackets allow for installation from below the ceiling. Suitable for ceiling thickness ranging from 5/8" to 1".

ELECTRICAL SYSTEM

- Die-cast aluminum lampholder housing.
- Medium-base porcelain socket with nickel-plated screw shell.
- Thermally protected, high-power-factor electronic ballast (50/60Hz) mounted to the junction box.
- Thermally activated insulation detector.

LISTING

- Fixtures are UL Listed, non-IC recessed mounting and damp locations.

WARRANTY

- 1-year limited warranty. Complete warranty terms located at: www.acuitybrands.com/CustomerResources/Terms_and_conditions.aspx

ORDERING INFORMATION

EXAMPLE: AH 150MHC 8AR T73 220

Series	Wattage/Lamp ¹	Aperture/Trim color	Finish	Lens type ^{3,5}	Voltage	Options
AHI	<u>Color-corrected metal halide²</u>	8AR Clear	(blank) Semi-specular	(blank) No lens	120	SF Single fuse
AHWI	70MHC	8PR Pewter	LD Matte-diffuse	CGL Clear glass lens	277	TRW White painted flange
	100MHC	8WTR Wheat		T73 Tempered prismatic lens		TRBL Black painted flange
	150MHC	8BR^{3,4} Black				GSKT Foam gasketing
		8WR^{3,4} White				

NOTES

ORDERING NOTES
<ol style="list-style-type: none"> 1. Recommended for use with coated lamps. 2. Ceramic arc tube consistent-color lamp. 3. AHI only. 4. Not available with finishes. 5. Required for use with enclosed rated lamps.

DIMENSIONAL DATA

All dimensions are inches (centimeters) unless otherwise noted.

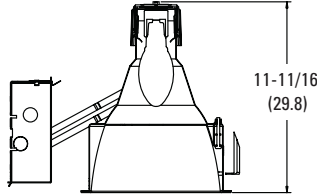
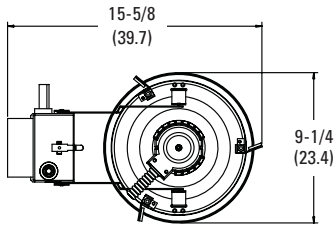

Aperture: 7-7/8 (20.1)
 Ceiling opening: 8-5/8 (21.9)
 Overlap trim: 9-1/4 (23.5)

ELECTRICAL

ENERGY (Calculated in accordance with NEMA standard LE-5A)						
LER.DOL	Annual* Energy Cost	Lamps	Lamp Lumens	Ballast Factor	Input Watts	
59	\$4.05	(1) 100M	8700	1.00	110	
54	\$4.44	(1) 100M	1200	1.00	169	
*Comparative yearly lighting energy cost per 1000 lumens						

Distribution Curve Distribution Data Output Data Coefficient of Utilization Illuminance: Single Luminaire 30" Above Floor

AHI 100MHC 8AR (1) MHC100/C/U/MED lamp, 8700 rated lumens, 1.3 s/mh, Test no. LTL7958

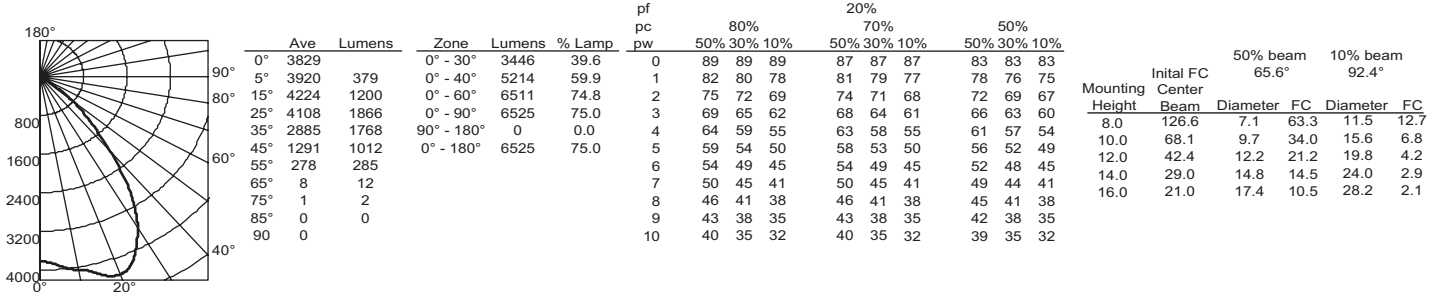

AHI 100MHC 8AR CGL (1) MHC100/C/U/MED lamp, 8700 rated lumens, 1.3 s/mh, Test no. LTL8011

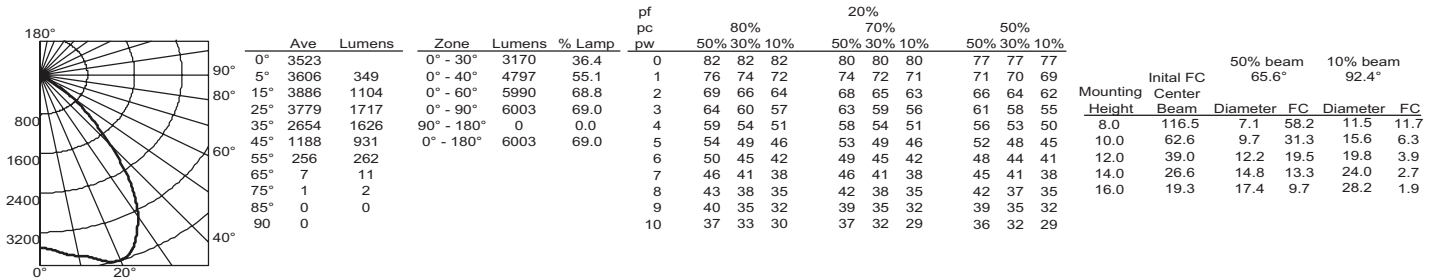

AHI 150M 8AR (1) MP150/C/U/MED lamp, 12000 rated lumens, 1.2 s/mh, Test no. LTL7959

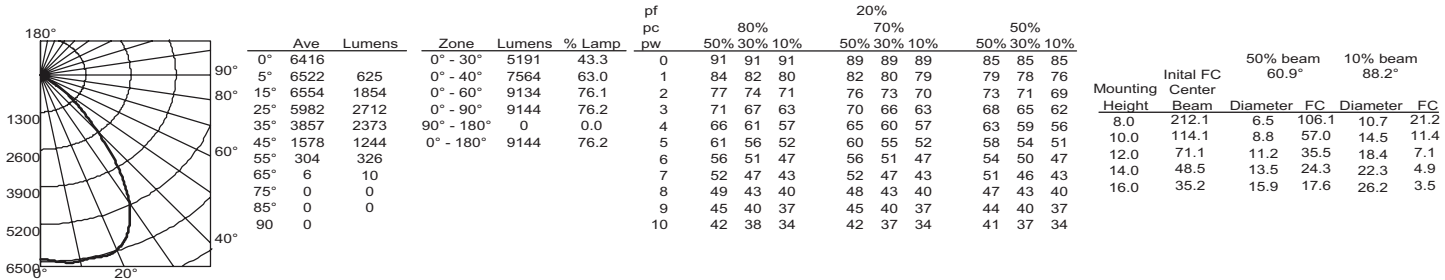

AHI 150M 8AR CGL (1) MP150/C/U/MED lamp, 12000 rated lumens, 1.2 s/mh, Test no. LTL8012

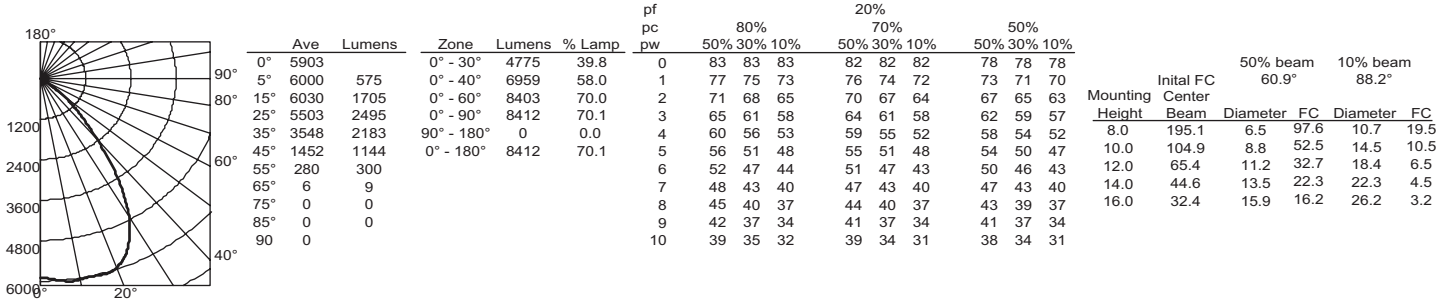

PHOTOMETRY NOTES

- Tested to current IES and NEMA standards under stabilized laboratory conditions.
- Actual performance may differ as a result of end-user environment and application.
- Consult factory or IES file for microgroove baffle, black cone or other photometric reports.