



Gotham Architectural Downlighting
Renovation Decorative Compact Fluorescent Downlights

8" PDTFI
Ice™ Turbo

Horizontal Triple-Tube Lamp

FEATURES

OPTICAL SYSTEM

- Reflector - Self-flanged, matte-finished clear anodized reflector. Fluted vertical upper section works in conjunction with patented Bounding Ray™ Optical Principle design (U.S. Patent No. 5,800,050) to provide lamp before lamp image and smooth transition from top of reflector to bottom. Minimum flange matches reflector finish. White painted flange optional.
- Turbo Baffle - Clear acrylic, three-spoke turbo baffle with surface that provides a decorative edge-glow appearance.
- Hinged lampdoor provided for optimal fixture efficiency and the reduction of stray light in the plenum.

MECHANICAL

- Pre-wired galvanized steel junction box mount to reflector provided with removable access cover. No. 12 AWG conductors rated for 90°C.
- Three (3) swinggate brackets allow for installation from below the ceiling. Suitable for ceiling thickness ranging from 5/8" (1.59cm) to 1" (2.54cm).

ELECTRICAL SYSTEM

- Horizontally-mounted, positive-latch, thermoplastic socket(s).
- Thermally protected, high power factor electronic ballast (50/60Hz) mounted to the junction box.

LISTING

- Fixtures are UL Listed, Non-IC recessed mounting and damp locations.

WARRANTY

- 1-year limited warranty. Complete warranty terms located at www.acuitybrands.com/CustomerResources/Terms_and_conditions.aspx

ORDERING INFORMATION

EXAMPLE: PDTFI 1/32TRT 8AR MVOLT

Series	Lamp/Wattage	Aperture/Trim	Voltage	Ballast	Options
PDTFI	1/18TRT	8AR Clear	MVOLT ¹	(blank) Electronic ballast	TRW White painted flange WLP With 3500 K lamp (shipped separately) GMF² Single, slow-blow fuse GLR² Single, fast-blow fuse GSKT Foam gasketing, ships uninstalled
	1/26TRT		120	ADEZ ² Advance Mark 10® electronic dimming ballast. Minimum dimming level 5%	
	1/32TRT		277	ECOS Lutron EcoSystem® electronic dimming ballast. Minimum dimming level 5%.	
	1/42TRT				
	2/18TRT				
	2/26TRT				
	2/32TRT				
	2/42TRT				

NOTES

ORDERING NOTES
1. Multi-volt electronic ballast capable of operating on any line voltage from 120V through 277V, 50 or 60Hz. 2. Available in 120V or 277V only.

DIMENSIONAL DATA

All dimensions are inches (centimeters) unless otherwise noted.

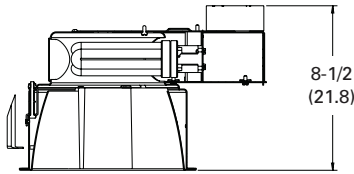
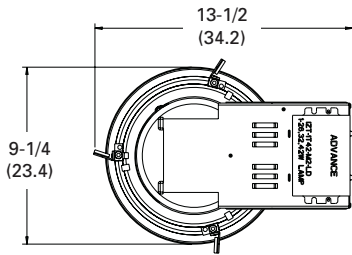

- Aperture: 7-7/8 (20)
- Ceiling Opening: 8-5/8 (21.9)
- Overlap Trim: 9-1/4 (23.5)

Distribution Curve Distribution Data Output Data Coefficient of Utilization Illuminance: Single Luminaire 30" Above Floor

PDTFI 1/32TRT 8AR (1) CF32DT/E/IN/835, 2400 lumens per lamp, Test no. LTL11858

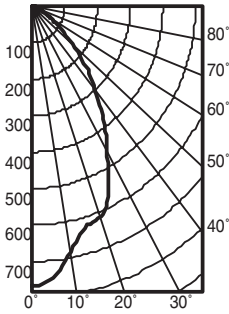

From 0°	Ave	Lumens	Zone	Lumens	% Lamp	pf	20%				50% beam angle		10% beam angle				
						pc	80%		70%		50%		52.4°		91.4°		
						pw	50%	30%	50%	30%	50%	30%	Initial fc	fc at	fc at	fc at	
													Mount at beam	Beam	beam	Beam	
													height	center	diameter	edge	diameter
0	767		0° - 30°	499.5	20.8	1	.49	.47	.48	.46	.46	.45	8	25.4	5.4	12.7	11.3
5	746	69	0° - 40°	736.0	30.7	2	.44	.42	.43	.41	.42	.40	10	13.6	7.4	6.8	15.4
15	629	179	0° - 60°	1012.1	42.2	3	.40	.37	.39	.37	.38	.36	12	8.5	9.4	4.3	19.5
25	555	251	0° - 90°	1078.1	44.9	4	.36	.33	.36	.33	.35	.32	14	5.8	11.3	2.9	23.6
35	381	237	90° - 180°	0.0	0.0	5	.33	.30	.33	.30	.32	.29	16	4.2	13.3	2.1	27.7
45	235	179	0° - 180°	1078.1	*44.9	6	.31	.27	.30	.27	.29	.27					
55	106	97			*Efficiency	7	.28	.25	.28	.25	.27	.24					
65	44	44				8	.26	.23	.26	.23	.25	.22					
75	16	17				9	.24	.21	.24	.21	.24	.21					
85	3	4				10	.23	.19	.22	.19	.22	.19					
90	0																

PDTFI 1/42TRT 8AR (1) CF42DT/E/IN/835, 3200 lumens per lamp, Test no. LTL11899

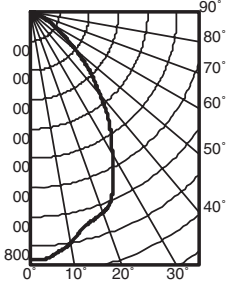

From 0°	Ave	Lumens	Zone	Lumens	% Lamp	pf	20%				50% beam angle		10% beam angle				
						pc	80%		70%		50%		55.5°		93.2°		
						pw	50%	30%	50%	30%	50%	30%	Initial fc	fc at	fc at	fc at	
													Mount at beam	Beam	beam	Beam	
													height	center	diameter	edge	diameter
0	843		0° - 30°	594.2	18.6	1	.45	.43	.44	.42	.42	.41	8	27.9	5.8	13.9	11.6
5	838	79	0° - 40°	885.9	27.7	2	.40	.38	.39	.37	.38	.36	10	15.0	7.9	7.5	15.9
15	750	213	0° - 60°	1228.8	38.4	3	.36	.34	.36	.33	.35	.33	12	9.3	10.0	4.7	20.1
25	667	302	0° - 90°	1319.9	41.2	4	.33	.30	.33	.30	.32	.29	14	6.4	12.1	3.2	24.3
35	472	292	90° - 180°	0.0	0.0	5	.30	.27	.30	.27	.29	.26	16	4.6	14.2	2.3	28.5
45	287	219	0° - 180°	1319.9	*41.2	6	.28	.25	.27	.24	.27	.24					
55	135	124			*Efficiency	7	.26	.22	.25	.22	.25	.22					
65	59	60				8	.24	.21	.23	.20	.23	.20					
75	23	25				9	.22	.19	.22	.19	.21	.19					
85	5	6				10	.20	.18	.20	.17	.20	.17					
90	0																

PDTFI 2/32TRT 8AR, (2) CF32DT/E/IN/835, 2400 lumens per lamp, Test no. LTL11861

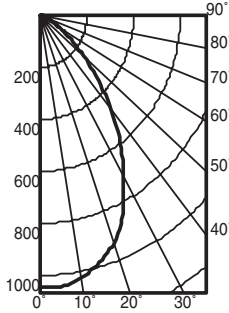

From 0°	Ave	Lumens	Zone	Lumens	% Lamp	pf	20%				50% beam angle		10% beam angle				
						pc	80%		70%		50%		56.3°		92.9°		
						pw	50%	30%	50%	30%	50%	30%	Initial fc	fc at	fc at	fc at	
													Mount at beam	Beam	beam	Beam	
													height	center	diameter	edge	diameter
0	1042		0° - 30°	756.8	15.8	1	.37	.36	.36	.35	.35	.34	8	34.4	5.9	17.2	11.6
5	1048	99	0° - 40°	1127.9	23.5	2	.34	.32	.33	.31	.32	.30	10	18.5	8.0	9.3	15.8
15	983	276	0° - 60°	1545.7	32.2	3	.30	.28	.30	.28	.29	.27	12	11.5	10.2	5.8	20.0
25	839	382	0° - 90°	1645.2	34.3	4	.28	.25	.27	.25	.27	.25	14	7.9	12.3	3.9	24.2
35	597	371	90° - 180°	0.0	0.0	5	.25	.23	.25	.23	.24	.22	16	5.7	14.5	2.9	28.4
45	352	272	0° - 180°	1645.2	*34.3	6	.23	.21	.23	.21	.22	.20					
55	158	146			*Efficiency	7	.21	.19	.21	.19	.21	.19					
65	65	67				8	.20	.17	.20	.17	.19	.17					
75	24	27				9	.18	.16	.18	.16	.18	.16					
85	5	6				10	.17	.15	.17	.15	.17	.15					
90	0																

PDTFI 2/42TRT 8AR (2) CF42DT/E/IN/835, 3200 lumens per lamp, Test no. LTL11860

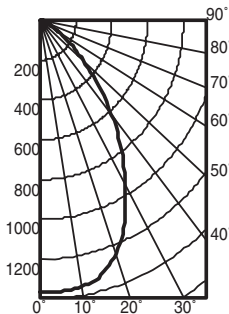

From 0°	Ave	Lumens	Zone	Lumens	% Lamp	pf	20%				50% beam angle		10% beam angle				
						pc	80%		70%		50%		57.0°		92.9°		
						pw	50%	30%	50%	30%	50%	30%	Initial fc	fc at	fc at	fc at	
													Mount at beam	Beam	beam	Beam	
													height	center	diameter	edge	diameter
0	1359		0° - 30°	1009.3	15.8	1	.37	.36	.36	.35	.35	.34	8	44.9	6.0	22.5	11.6
5	1365	130	0° - 40°	1500.8	23.5	2	.33	.32	.33	.31	.32	.30	10	24.2	8.1	12.1	15.8
15	1322	370	0° - 60°	2044.8	32.0	3	.30	.28	.30	.28	.29	.27	12	15.1	10.3	7.5	20.0
25	1119	509	0° - 90°	2173.9	34.0	4	.28	.25	.27	.25	.26	.24	14	10.3	12.5	5.1	24.2
35	792	492	90° - 180°	0.0	0.0	5	.25	.23	.25	.22	.24	.22	16	7.5	14.7	3.7	28.4
45	461	355	0° - 180°	2173.9	*34.0	6	.23	.21	.23	.20	.22	.20					
55	205	189			*Efficiency	7	.21	.19	.21	.19	.21	.18					
65	85	86				8	.20	.17	.20	.17	.19	.17					
75	32	34				9	.18	.16	.18	.16	.18	.16					
85	7	8				10	.17	.15	.17	.15	.17	.15					
90	0																

PHOTOMETRY NOTES

- Tested to current IES and NEMA standards under stabilized laboratory conditions.
- Actual performance may differ as a result of end-user environment and application.
- Consult factory or IES file for microgroove baffle, black cone or other photometric reports.