



Gotham Architectural Downlighting  
Decorative Fluorescent Downlights

**6" AFV**  
**Drop Luminous Ring/Disk**

Vertical Lamp  
Double Twin-Tube or Triple-Tube

FEATURES

**OPTICAL SYSTEM**

- Self-flanged semi-specular or matte-diffuse reflector.
- Patented Vertisys® - Bounding Ray™ Optical Principle design (US Patent No. 5,800,050).
- Decorative element: 3/16"-thick low-iron glass with polished edges and sandblasted finish. Ring or disk style available. Precision-machined aluminum hardware with threaded spacers for easy maintenance.

**MECHANICAL SYSTEM**

- 16-gauge galvanized steel construction; maximum 1-5/8" ceiling thickness.
- Telescopic mounting bars maximum of 32" and minimum of 15", preinstalled, 4" vertical adjustment.
- Toolless post-installation adjustments.
- Junction box capacity: 8 (4 in, 4 out) 12AWG rated for 90°C.

**ELECTRICAL SYSTEM**

- Rugged aluminum lampholder housing.
- Vertically mounted, four-pin, positive-latch, thermoplastic socket.
- Class P, thermally protected, high-power-factor electronic ballast mounted to the junction box.
- SIMPLY5™ technology available.

**LISTING**

- Fixtures are UL Listed for thru-branch wiring, non-IC recessed mounting and damp locations. Listed and labeled to comply with Canadian standards.

**WARRANTY**

- 1-year limited warranty. Complete warranty terms located at [www.acuitybrands.com/CustomerResources/Terms\\_and\\_conditions.aspx](http://www.acuitybrands.com/CustomerResources/Terms_and_conditions.aspx)

**EXAMPLE: AFV 32TRT 6AR DLR MVOLT WLP**

Series	Wattage/Lamp	Aperture/Trim color	Decorative element	Finish	Voltage	Ballast <sup>3</sup>
AFV	13DTT	6AR Clear	DLR Drop luminous ring	(blank) Semi-specular	MVOLT <sup>2</sup>	(blank) Electronic ballast
	18DTT		DLR Drop luminous disk	LD Matte-diffuse	120	ECOS <sup>2,4</sup> Lutron® EcoSystem® electronic dimming ballast. Minimum dimming level 5%
	26DTT	6PR Pewter			277	ADEZ <sup>4,5</sup> Advance Mark 10® electronic dimming ballast. Minimum dimming level 5%
	13TRT	6WTR Wheat			347	ADZT <sup>2</sup> Advance Mark 7® electronic dimming ballast. Minimum dimming level 5%
	18TRT	6WR <sup>1</sup> White painted				S5 <sup>6</sup> SIMPLY5™ system ballast. Minimum dimming level 3%
	26TRT					
	32TRT					
	42TRT					

ORDERING INFORMATION

Options

ELR <sup>5,7</sup>	Emergency battery pack with remote test switch	BDP <sup>9,10</sup>	Ballast disconnect plug
EL <sup>5,7</sup>	Emergency battery pack with integral test switch	NEPP	Interface for Sensor Switch® nLight® network with integrated power supply. Refer to TN-623-01.
ELHL <sup>5,7</sup>	High-lumen-output emergency battery pack with integral test switch	WRL <sup>11</sup>	Wattage restriction label
ELRHL <sup>5,7</sup>	High-lumen-output emergency battery pack with remote test switch	TWS	Twist lock socket
GMF <sup>5</sup>	Single, slow-blow fuse		
GLR <sup>5</sup>	Single, fast-blow fuse		
TRW	White painted flange (standard on WR)		
TRBL	Black painted flange		
GSKT	Foam gasketing		
WLP	With 3500 K lamp (shipped separately)		
HW	Hardwire for S5 system; replaces RELOC®		
RRL <sup>8</sup>	RELOC®-ready luminaire. Provides compatibility with Lithonia RELOC system. Access above ceiling required.		
CP <sup>9</sup>	Chicago plenum		

## 6" AFV

### Drop Luminous Ring/Disk

Vertical Lamp, Double Twin-Tube or Triple-Tube



DIMENSIONAL DATA

All dimensions are inches (centimeters) unless otherwise noted.

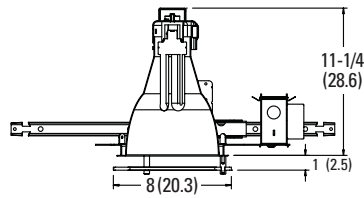
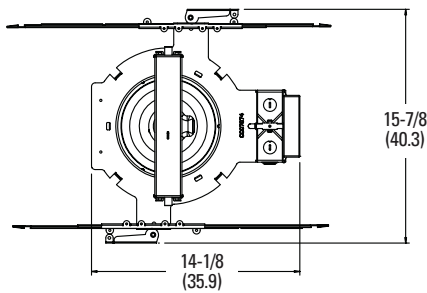

Aperture: 6-1/4 (15.9)  
Ceiling opening: 7-1/8 (18.1)  
Overlap trim: 7-1/2 (19.1)

#### DIMENSIONAL NOTES

- Maximum height depends on lamp wattage/type, dimensions range from 11-1/4" for 18DTT, 26DTT and 42TRT; 10-1/16" for 13DTT, 18TRT, 26TRT and 32TRT.

NOTES

#### ORDERING NOTES

1. Not available with finishes.
2. Multi-volt electronic ballast capable of operating on any voltage from 120V through 277V, 50 or 60 Hz.
3. For additional ballast types, refer to [TECH-250](#).
4. Not available with 13W.
5. Available in 120V or 277V only.
6. SIMPLY5 includes 9' S5 MLC RELOC wiring system (shipped separately). Available in 120V or 277V only. Not available in 13W or 18W. See [simply5.net](#) for more information.
7. For dimensional changes, refer to [TECH-140](#).
8. For compatible RELOC systems, refer to [TECH-110](#).
9. Not available with emergency option.
10. Meets codes that require in-fixture disconnect.
11. Must specify wattage. Ex.: WRL18

Distribution Curve    Distribution Data    Output Data    Coefficient of Utilization    Illuminance: Single Luminaire 30" Above Floor

**AFV 26TRT 6AR DLD**

(1) CF26TRT, 1800 LUMENS PER LAMP, 0.8 S/MH, TEST NO. LTL19758

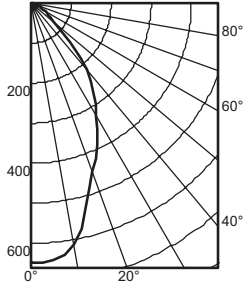

Ave Lumens	Zone Lumens % Lamp	pf pc pw	80%			70%			50%					
			50%	30%	10%	50%	30%	10%	50%	30%	10%			
0	649	0° - 30°	385.6	21.4	0	51	51	51	49	49	49	47	47	47
5	645	0° - 40°	555.0	30.8	1	46	45	43	45	44	43	43	42	41
15	529	0° - 60°	709.1	39.4	2	42	40	38	41	39	37	40	38	36
25	389	0° - 90°	763.0	42.4	3	38	35	33	37	35	33	36	34	33
35	273	90° - 120°	2.4	0.1	4	35	32	30	34	32	30	33	31	29
45	139	90° - 130°	2.4	0.1	5	32	29	27	32	29	27	31	28	26
55	51	90° - 150°	2.4	0.1	6	30	27	24	29	26	24	29	26	24
65	30	90° - 180°	2.4	0.1	7	28	25	22	27	24	22	27	24	22
75	17	0° - 180°	765.4	*42.5	8	26	23	21	25	23	21	25	22	20
85	5				9	24	21	19	24	21	19	23	21	19
90	2				10	22	20	18	22	20	18	22	19	18

Mounting Height	Initial FC Center		50% beam -		10% beam -	
	Beam	Diameter	FC	Diameter	FC	Diameter
8.0	21.5	4.6	10.7	10.4	2.1	
10.0	11.5	6.3	5.8	14.2	1.2	
12.0	7.2	8.0	3.6	17.9	0.7	
14.0	4.9	9.7	2.5	21.7	0.5	
16.0	3.6	11.4	1.8	25.5	0.4	

**AFV 26TRT 6AR DLR**

(1) CF26TRT, 1800 LUMENS PER LAMP, 0.9 S/MH, TEST NO. LTL19746

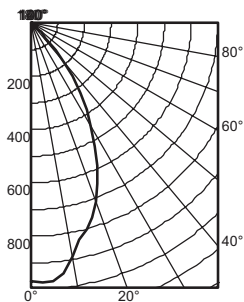

Ave Lumens	Zone Lumens % Lamp	pf pc pw	80%			70%			50%					
			50%	30%	10%	50%	30%	10%	50%	30%	10%			
0	966	0° - 30°	582.2	32.3	0	59	59	59	57	57	57	55	55	55
5	973	0° - 40°	779.9	43.3	1	54	53	52	53	52	51	51	50	49
15	802	0° - 60°	869.8	48.3	2	50	48	46	49	48	46	48	46	45
25	592	0° - 90°	888.7	49.4	3	47	44	42	46	44	42	45	43	41
35	323	90° - 120°	1.0	0.1	4	43	41	38	43	40	38	42	39	38
45	79	90° - 130°	1.0	0.1	5	40	37	35	40	37	35	39	37	35
55	20	90° - 150°	1.0	0.1	6	38	35	33	37	35	32	37	34	32
65	11	90° - 180°	1.1	0.1	7	35	32	30	35	32	30	34	32	30
75	6	0° - 180°	889.8	*49.4	8	33	30	28	33	30	28	32	30	28
85	2				9	31	28	26	31	28	26	31	28	26
90	1				10	30	27	25	29	27	25	29	26	25

Mounting Height	Initial FC Center		50% beam -		10% beam -	
	Beam	Diameter	FC	Diameter	FC	Diameter
8.0	31.9	4.8	16.0	9.0	3.2	
10.0	17.2	6.6	8.6	12.3	1.7	
12.0	10.7	8.3	5.4	15.5	1.1	
14.0	7.3	10.0	3.7	18.8	0.7	
16.0	5.3	11.8	2.6	22.1	0.5	

**AFV 32TRT 6AR DLD**

(1) CF32TRT, 2400 LUMENS PER LAMP, 1.0 S/MH, TEST NO. LTL19759

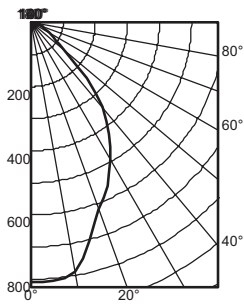

Ave Lumens	Zone Lumens % Lamp	pf pc pw	80%			70%			50%					
			50%	30%	10%	50%	30%	10%	50%	30%	10%			
0	810	0° - 30°	530.2	22.1	0	58	58	58	56	56	56	54	54	54
5	809	0° - 40°	793.5	33.1	1	52	51	49	51	50	48	49	48	47
15	703	0° - 60°	1067.4	44.5	2	47	45	42	46	44	42	45	43	41
25	561	0° - 90°	1159.2	48.3	3	43	40	37	42	39	37	41	38	36
35	424	90° - 120°	3.7	0.2	4	39	36	33	38	35	33	37	34	32
45	246	90° - 130°	3.7	0.2	5	36	32	29	35	32	29	34	31	29
55	95	90° - 150°	3.7	0.2	6	33	29	27	32	29	26	32	29	26
65	52	90° - 180°	3.7	0.2	7	30	27	24	30	26	24	29	26	24
75	28	0° - 180°	1163.0	*48.5	8	28	25	22	28	24	22	27	24	22
85	8				9	26	23	20	26	23	20	25	22	20
90	3				10	24	21	19	24	21	19	24	21	19

Mounting Height	Initial FC Center		50% beam -		10% beam -	
	Beam	Diameter	FC	Diameter	FC	Diameter
8.0	26.8	5.3	13.4	11.2	2.7	
10.0	14.4	7.2	7.2	15.2	1.4	
12.0	9.0	9.1	4.5	19.3	0.9	
14.0	6.1	11.0	3.1	23.4	0.6	
16.0	4.4	13.0	2.2	27.4	0.4	

**AFV 32TRT 6AR DLR**

(1) CF32TRT, 2400 LUMENS PER LAMP, 1.0 S/MH, TEST NO. LTL19747

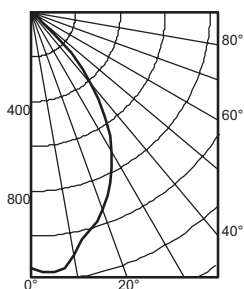

Ave Lumens	Zone Lumens % Lamp	pf pc pw	80%			70%			50%					
			50%	30%	10%	50%	30%	10%	50%	30%	10%			
0	1142	0° - 30°	776.2	32.3	0	68	68	68	67	67	67	64	64	64
5	1166	0° - 40°	1131.6	47.2	1	63	61	60	62	60	59	59	58	57
15	1010	0° - 60°	1348.0	56.2	2	58	55	53	57	54	52	55	53	51
25	836	0° - 90°	1375.0	57.3	3	53	50	48	52	50	47	51	48	46
35	574	90° - 120°	1.6	0.1	4	49	46	43	49	45	43	47	44	42
45	257	90° - 130°	1.8	0.1	5	46	42	39	45	41	39	44	41	38
55	31	90° - 150°	1.8	0.1	6	42	38	36	42	38	36	41	38	35
65	15	90° - 180°	1.8	0.1	7	39	35	33	39	35	33	38	35	32
75	9	0° - 180°	1376.8	*57.4	8	37	33	30	36	33	30	36	32	30
85	3				9	34	31	28	34	30	28	33	30	28
90	1				10	32	28	26	32	28	26	31	28	26

Mounting Height	Initial FC Center		50% beam -		10% beam -	
	Beam	Diameter	FC	Diameter	FC	Diameter
8.0	37.8	5.5	18.9	10.5	3.8	
10.0	20.3	7.5	10.2	14.3	2.0	
12.0	12.7	9.5	6.3	18.1	1.3	
14.0	8.6	11.5	4.3	22.0	0.9	
16.0	6.3	13.5	3.1	25.8	0.6	

**PHOTOMETRY NOTES**

- Tested to current IES and NEMA standards under stabilized laboratory condition.
- Actual performance may differ as a result of end-user environment and application.
- Consult factory or IES file for microgroove baffle, black cone or other photometric reports.