



Gotham Architectural Downlighting
Decorative Fluorescent Downlights

8" AFV
Drop Luminous Ring/Disk

Vertical Lamp
Double Twin-Tube or Triple-Tube

FEATURES

OPTICAL SYSTEM

- Self-flanged semi-specular or matte-diffuse reflector.
- Patented Vertisys® - Bounding Ray™ Optical Principle design (US Patent No. 5,800,050).
- Decorative element: 3/16"-thick low-lead glass with polished edges and sandblasted finish. Ring or disk style available. Precision-machined aluminum hardware with threaded spacers for easy maintenance.

MECHANICAL SYSTEM

- 16-gauge galvanized steel construction; maximum 1-5/8" ceiling thickness.
- Telescopic mounting bars maximum of 32" and minimum of 15", preinstalled, 4" vertical adjustment.
- Toolless post-installation adjustments.
- Junction box capacity: 8 (4 in, 4 out) 12AWG rated for 90°C.

ELECTRICAL SYSTEM

- Rugged aluminum lampholder housing.
- Vertically mounted, four-pin, positive-latch, thermoplastic socket.
- Class P, thermally protected, high-power-factor electronic ballast mounted to the junction box.
- SIMPLY5™ technology available.

LISTING

- Fixtures are UL Listed for thru-branch wiring, non-IC recessed mounting and damp locations. Listed and labeled to comply with Canadian standards.

WARRANTY

- 1-year limited warranty. Complete warranty terms located at www.acuitybrands.com/CustomerResources/Terms_and_conditions.aspx

EXAMPLE: AFV 32TRT 8AR DLR MVOLT WLP

| Series | Wattage/Lamp | Aperture/Trim color | Decorative element | Finish | Voltage | Ballast ³ |
|--------|--------------|--------------------------------|------------------------|-----------------------|--------------------|---|
| AFV | 13DTT | 8AR Clear | DLR Drop luminous ring | (blank) Semi-specular | MVOLT ² | (blank) Electronic ballast |
| | 18DTT | 8PR Pewter | DLD Drop luminous disk | LD Matte-diffuse | 120 | ECOS ^{2,4} Lutron® EcoSystem® electronic dimming ballast. Minimum dimming level 5% |
| | 26DTT | 8WTR Wheat | | | 277 | ADEZ ^{4,6} Advance Mark 10® electronic dimming ballast. Minimum dimming level 5% |
| | 13TRT | 8WR ¹ White painted | | | 347 | ADZT ² Advance Mark 7® electronic dimming ballast. Minimum dimming level 5% |
| | 18TRT | | | | | S5 ⁵ SIMPLY5™ system ballast. Minimum dimming level 3% |
| | 26TRT | | | | | |
| | 32TRT | | | | | |
| | 42TRT | | | | | |

ORDERING INFORMATION

| Options | | | |
|----------------------|---|---------------------|---|
| ELR ^{6,7} | Emergency battery pack with remote test switch | BDP ^{9,10} | Ballast disconnect plug |
| EL ^{6,7} | Emergency battery pack with integral test switch | NEPP | Interface with Sensor Switch® nLight® network with integral power supply. Refer to TN-623-01. |
| ELHL ^{6,7} | High-lumen-output emergency battery pack with integral test switch | WRL ¹¹ | Wattage restriction label |
| ELRHL ^{6,7} | High-lumen-output emergency battery pack with remote test switch | TWS | Twist lock socket |
| GMF ⁶ | Single, slow-blow fuse | | |
| GLR ⁶ | Single, fast-blow fuse | | |
| TRW | White painted flange (standard on WR) | | |
| TRBL | Black painted flange | | |
| GSKT | Foam gasketing | | |
| WLP | With 3500 K lamp (shipped separately) | | |
| RRL ⁸ | RELOC®-ready luminaire. Provides compatibility with Lithonia RELOC system. Access above ceiling required. | | |
| HW | Hardware for S5 system; replaces RELOC® | | |
| CP ⁹ | Chicago plenum | | |

8" AFV

Drop Luminous Ring/Disk

Vertical Lamp, Double Twin-Tube or Triple-Tube



DIMENSIONAL DATA

All dimensions are inches (centimeters) unless otherwise noted.

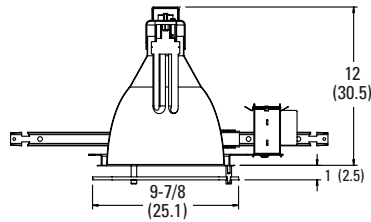
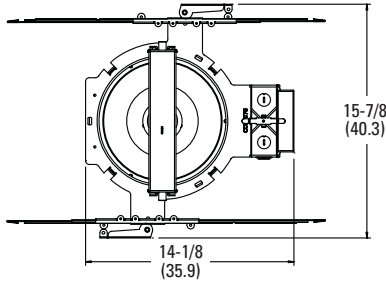

Aperture: 7-7/8 (20.1)
Ceiling opening: 8-7/8 (21.5)
Overlap trim: 9-1/4 (23.5)

DIMENSIONAL NOTES

- Maximum height depends on lamp wattage/type, dimensions range from 12" for 18DTT, 26DTT and 42TRT; 10-3/4" for 13DDT, 18TRT, 26TRT and 32TRT.

NOTES

ORDERING NOTES

- Not available with finishes.
- Multi-volt electronic ballast capable of operating on any voltage from 120V through 277V, 50 or 60 Hz.
- For additional ballast types, refer to [TECH-250](#).
- Available in 18W, 26W, 32W or 42W.
- SIMPLY5 includes 9' S5 MLC RELOC wiring system (shipped separately). Available in 26W, 32W or 42W; 120V or 277V only. See [simply5.net](#) for more information.
- Available in 120V or 277V only.
- For dimensional changes, refer to [TECH-140](#).
- For compatible RELOC systems, refer to [TECH-110](#).
- Not available with emergency option.
- Meets codes that require in-fixture disconnect.
- Must specify wattage: Ex.: WRL32

Distribution Curve Distribution Data Output Data Coefficient of Utilization Illuminance: Single Luminaire 30" Above Floor

AFV 32TRT 8AR DLD

(1) CF32TRT, 2400 LUMENS PER LAMP, 0.9 S/MH, TEST NO. LTL19825

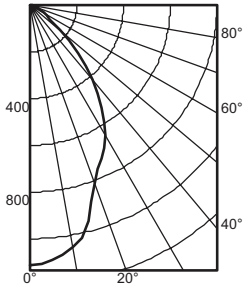

| Ave | Lumens | Zone | Lumens | % Lamp | pf | 80% | | | 70% | | | 50% | | |
|-----|--------|------------|--------|--------|----|-----|----|-------------|-------------|-------------|-------------|-------------|----|----|
| | | | | | | pc | pw | 50% 30% 10% | 50% 30% 10% | 50% 30% 10% | 50% 30% 10% | 50% 30% 10% | | |
| 0 | 1115 | 0° - 30° | 700.1 | 29.2 | 0 | 71 | 71 | 71 | 70 | 70 | 70 | 67 | 67 | 67 |
| 5 | 1096 | 0° - 40° | 1032.2 | 43.0 | 1 | 65 | 63 | 61 | 64 | 62 | 60 | 61 | 60 | 59 |
| 15 | 959 | 0° - 60° | 1350.9 | 56.3 | 2 | 59 | 56 | 53 | 58 | 55 | 53 | 56 | 54 | 52 |
| 25 | 725 | 0° - 90° | 1441.1 | 60.0 | 3 | 54 | 50 | 47 | 53 | 49 | 47 | 51 | 48 | 46 |
| 35 | 536 | 90° - 180° | 0.0 | 0.0 | 4 | 49 | 45 | 42 | 48 | 45 | 42 | 47 | 44 | 41 |
| 45 | 295 | 0° - 180° | 1441.1 | *60.0 | 5 | 45 | 41 | 38 | 45 | 41 | 38 | 43 | 40 | 37 |
| 55 | 102 | | | | 6 | 42 | 37 | 34 | 41 | 37 | 34 | 40 | 36 | 34 |
| 65 | 52 | | | | 7 | 39 | 34 | 31 | 38 | 34 | 31 | 37 | 34 | 31 |
| 75 | 27 | | | | 8 | 36 | 32 | 29 | 35 | 31 | 29 | 35 | 31 | 28 |
| 85 | 8 | | | | 9 | 33 | 29 | 26 | 33 | 29 | 26 | 32 | 29 | 26 |
| 90 | 2 | | | | 10 | 31 | 27 | 24 | 31 | 27 | 24 | 30 | 27 | 24 |

| Mounting Height | Initial Center Beam | 50% beam - 48.5° | | 10% beam - 89.0° | |
|-----------------|---------------------|------------------|------|------------------|-----|
| | | Diameter | FC | Diameter | FC |
| 8.0 | 36.9 | 5.0 | 18.4 | 10.8 | 3.7 |
| 10.0 | 19.8 | 6.8 | 9.9 | 14.7 | 2.0 |
| 12.0 | 12.4 | 8.6 | 6.2 | 18.7 | 1.2 |
| 14.0 | 8.4 | 10.4 | 4.2 | 22.6 | 0.8 |
| 16.0 | 6.1 | 12.2 | 3.1 | 26.5 | 0.6 |

AFV 32TRT 8AR DLR

(1) CF32TRT, 2400 LUMENS PER LAMP, 0.9 S/MH, TEST NO. LTL19826

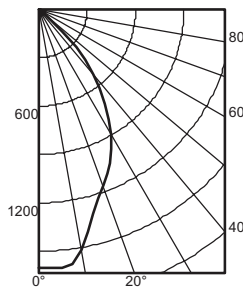

| Ave | Lumens | Zone | Lumens | % Lamp | pf | 80% | | | 70% | | | 50% | | |
|-----|--------|------------|--------|--------|----|-----|----|-------------|-------------|-------------|-------------|-------------|----|----|
| | | | | | | pc | pw | 50% 30% 10% | 50% 30% 10% | 50% 30% 10% | 50% 30% 10% | 50% 30% 10% | | |
| 0 | 1599 | 0° - 30° | 997.1 | 41.5 | 0 | 86 | 86 | 86 | 84 | 84 | 84 | 80 | 80 | 80 |
| 5 | 1612 | 0° - 40° | 1438.5 | 59.9 | 1 | 79 | 77 | 76 | 78 | 76 | 75 | 75 | 74 | 72 |
| 15 | 1309 | 0° - 60° | 1711.2 | 71.3 | 2 | 73 | 70 | 67 | 72 | 69 | 67 | 70 | 67 | 65 |
| 25 | 1048 | 0° - 90° | 1735.9 | 72.3 | 3 | 68 | 64 | 60 | 67 | 63 | 60 | 65 | 61 | 59 |
| 35 | 711 | 90° - 180° | 0.0 | 0.0 | 4 | 62 | 58 | 55 | 62 | 57 | 54 | 60 | 56 | 54 |
| 45 | 326 | 0° - 180° | 1735.9 | *72.3 | 5 | 58 | 53 | 50 | 57 | 53 | 50 | 56 | 52 | 49 |
| 55 | 32 | | | | 6 | 54 | 49 | 46 | 53 | 49 | 45 | 52 | 48 | 45 |
| 65 | 14 | | | | 7 | 50 | 45 | 42 | 50 | 45 | 42 | 49 | 45 | 42 |
| 75 | 7 | | | | 8 | 47 | 42 | 39 | 46 | 42 | 39 | 45 | 41 | 38 |
| 85 | 3 | | | | 9 | 44 | 39 | 36 | 43 | 39 | 36 | 43 | 39 | 36 |
| 90 | 1 | | | | 10 | 41 | 37 | 33 | 41 | 36 | 33 | 40 | 36 | 33 |

| Mounting Height | Initial Center Beam | 50% beam - 48.9° | | 10% beam - 86.0° | |
|-----------------|---------------------|------------------|------|------------------|-----|
| | | Diameter | FC | Diameter | FC |
| 8.0 | 52.9 | 5.0 | 26.4 | 10.3 | 5.3 |
| 10.0 | 28.4 | 6.8 | 14.2 | 14.0 | 2.8 |
| 12.0 | 17.7 | 8.6 | 8.9 | 17.7 | 1.8 |
| 14.0 | 12.1 | 10.5 | 6.0 | 21.4 | 1.2 |
| 16.0 | 8.8 | 12.3 | 4.4 | 25.2 | 0.9 |

AFV 42TRT 8AR DLD

(1) CF42TRT, 3200 LUMENS PER LAMP, 0.8 S/MH, TEST NO. LTL19823

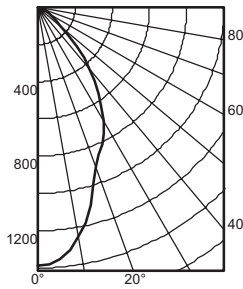

| Ave | Lumens | Zone | Lumens | % Lamp | pf | 80% | | | 70% | | | 50% | | |
|-----|--------|------------|--------|--------|----|-----|----|-------------|-------------|-------------|-------------|-------------|----|----|
| | | | | | | pc | pw | 50% 30% 10% | 50% 30% 10% | 50% 30% 10% | 50% 30% 10% | 50% 30% 10% | | |
| 0 | 1390 | 0° - 30° | 801.4 | 25.0 | 0 | 58 | 58 | 58 | 57 | 57 | 57 | 54 | 54 | 54 |
| 5 | 1360 | 0° - 40° | 1153.3 | 36.0 | 1 | 53 | 51 | 50 | 52 | 50 | 49 | 50 | 49 | 48 |
| 15 | 1096 | 0° - 60° | 1466.3 | 45.8 | 2 | 48 | 46 | 44 | 47 | 45 | 43 | 46 | 44 | 42 |
| 25 | 815 | 0° - 90° | 1557.4 | 48.7 | 3 | 44 | 41 | 39 | 43 | 41 | 38 | 42 | 40 | 38 |
| 35 | 563 | 90° - 180° | 0.0 | 0.0 | 4 | 40 | 37 | 35 | 40 | 37 | 34 | 39 | 36 | 34 |
| 45 | 293 | 0° - 180° | 1557.4 | *48.7 | 5 | 37 | 34 | 31 | 37 | 33 | 31 | 36 | 33 | 31 |
| 55 | 98 | | | | 6 | 34 | 31 | 28 | 34 | 31 | 28 | 33 | 30 | 28 |
| 65 | 52 | | | | 7 | 32 | 28 | 26 | 32 | 28 | 26 | 31 | 28 | 26 |
| 75 | 27 | | | | 8 | 30 | 26 | 24 | 29 | 26 | 24 | 29 | 26 | 24 |
| 85 | 8 | | | | 9 | 28 | 24 | 22 | 27 | 24 | 22 | 27 | 24 | 22 |
| 90 | 3 | | | | 10 | 26 | 23 | 21 | 26 | 23 | 21 | 25 | 22 | 21 |

| Mounting Height | Initial Center Beam | 50% beam - 43.8° | | 10% beam - 85.9° | |
|-----------------|---------------------|------------------|------|------------------|-----|
| | | Diameter | FC | Diameter | FC |
| 8.0 | 46.0 | 4.4 | 23.0 | 10.2 | 4.6 |
| 10.0 | 24.7 | 6.0 | 12.4 | 14.0 | 2.5 |
| 12.0 | 15.4 | 7.6 | 7.7 | 17.7 | 1.5 |
| 14.0 | 10.5 | 9.2 | 5.3 | 21.4 | 1.1 |
| 16.0 | 7.6 | 10.8 | 3.8 | 25.1 | 0.8 |

AFV 42TRT 8AR DLR

(1) CF42TRT, 3200 LUMENS PER LAMP, 0.8 S/MH, TEST NO. LTL19824

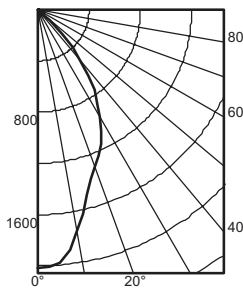

| Ave | Lumens | Zone | Lumens | % Lamp | pf | 80% | | | 70% | | | 50% | | |
|-----|--------|------------|--------|--------|----|-----|----|-------------|-------------|-------------|-------------|-------------|----|----|
| | | | | | | pc | pw | 50% 30% 10% | 50% 30% 10% | 50% 30% 10% | 50% 30% 10% | 50% 30% 10% | | |
| 0 | 2020 | 0° - 30° | 1129.7 | 35.3 | 0 | 69 | 69 | 69 | 67 | 67 | 67 | 64 | 64 | 64 |
| 5 | 1982 | 0° - 40° | 1600.0 | 50.0 | 1 | 64 | 62 | 61 | 63 | 61 | 60 | 60 | 59 | 58 |
| 15 | 1489 | 0° - 60° | 1830.9 | 57.2 | 2 | 59 | 57 | 54 | 58 | 56 | 54 | 56 | 54 | 53 |
| 25 | 1160 | 0° - 90° | 1856.7 | 58.0 | 3 | 55 | 52 | 49 | 54 | 51 | 49 | 52 | 50 | 48 |
| 35 | 766 | 90° - 180° | 0.0 | 0.0 | 4 | 51 | 47 | 45 | 50 | 47 | 44 | 49 | 46 | 44 |
| 45 | 266 | 0° - 180° | 1856.7 | *58.0 | 5 | 47 | 43 | 41 | 47 | 43 | 41 | 45 | 43 | 40 |
| 55 | 29 | | | | 6 | 44 | 40 | 38 | 43 | 40 | 37 | 43 | 39 | 37 |
| 65 | 15 | | | | 7 | 41 | 37 | 35 | 41 | 37 | 35 | 40 | 37 | 34 |
| 75 | 8 | | | | 8 | 38 | 35 | 32 | 38 | 35 | 32 | 37 | 34 | 32 |
| 85 | 3 | | | | 9 | 36 | 32 | 30 | 36 | 32 | 30 | 35 | 32 | 30 |
| 90 | 1 | | | | 10 | 34 | 30 | 28 | 34 | 30 | 28 | 33 | 30 | 28 |

| Mounting Height | Initial Center Beam | 50% beam - 43.4° | | 10% beam - 82.1° | |
|-----------------|---------------------|------------------|------|------------------|-----|
| | | Diameter | FC | Diameter | FC |
| 8.0 | 66.8 | 4.4 | 33.4 | 9.6 | 6.7 |
| 10.0 | 35.9 | 6.0 | 18.0 | 13.1 | 3.6 |
| 12.0 | 22.4 | 7.6 | 11.2 | 16.5 | 2.2 |
| 14.0 | 15.3 | 9.2 | 7.6 | 20.0 | 1.5 |
| 16.0 | 11.1 | 10.8 | 5.5 | 23.5 | 1.1 |

PHOTOMETRY NOTES

- Tested to current IES and NEMA standards under stabilized laboratory condition.
- Actual performance may differ as a result of end-user environment and application.
- Consult factory or IES file for microgroove baffle, black cone or other photometric reports.