

Gotham Architectural Downlighting
Compact Fluorescent Downlights



8" LGFLP
Non-Conductive Shower Light

Lensed Low Profile
Triple-Tube Lamp



FEATURES

OPTICAL SYSTEM

- Aluminum upper reflector coated with highly reflective white paint provides high efficiency and an evenly illuminated aperture appearance.
- Lens door made of impact-modified acrylic provides excellent durability and light transmission. "Dead front" shower light for added safety.

MECHANICAL SYSTEM

- 16-gauge galvanized steel mounting/plaster frame. Maximum 1-1/4" ceiling thickness.
- 16-gauge galvanized steel mounting bars with continuous 4" vertical adjustment are shipped pre-installed. Post-installation adjustment possible without the use of tools from above or below ceiling.
- Galvanized steel junction box with hinged access covers and spring latch. Two combination 1/2"-3/4" and three 1/2" knockouts for straight-through conduit runs. Capacity: 8 (4 in, 4 out) No. 12 AWG conductors rated for 90°C.
- Low-profile design allows for 4-3/4" fixture depth above ceiling.

ELECTRICAL SYSTEM

- Galvanized steel lampholder housing.
- Horizontally mounted, four-pin, positive-latch, thermoplastic socket(s).
- Class P, thermally protected, high-power-factor electronic ballast(s) mounted to the junction box.

LISTING

- Fixtures are UL Listed for thru-branch wiring, non-IC recessed mounting and wet locations. Listed and labeled to comply with Canadian standards.
- IP65 rated.

WARRANTY

- 1-year limited warranty. Complete warranty terms located at: www.acuitybrands.com/CustomerResources/Terms_and_conditions.aspx

ORDERING INFORMATION

EXAMPLE: LGFLP 1/26TRT 8DFR MVOLT

Series	Wattage/Lamp	Door frame	Voltage	Ballast	Options
LGFLP	1/18TRT	8DFR Dead (non-conductive) front regressed	MVOLT ²	(blank) Electronic ballast	ELR⁵ Emergency battery pack, remote test switch ELRHL⁵ High lumen output emergency battery pack, remote test switch provided GMF³ Single, slow-blow fuse GLR³ Single, fast-blow fuse TRW White painted flange DS Dual switching CP⁶ Chicago plenum WLP With 3500 K lamp (shipped separately) NPP16D EFP nLight network power/relay pack with 0-10V dimming. NPP16D ER EFP nLight network power/relay pack with 0-10V dimming. ER controls fixtures on emergency circuit.
	1/26TRT ¹		120	ECOS ³ EcoSystem® electronic dimming ballast. Minimum dimming level 5%	
	1/32TRT	8DFD Dead (non-conductive) front drop	277	ADEZ ^{3,4} Advance Mark 10® electronic dimming ballast. Minimum dimming level 5%	
	1/42TRT		347	ADZT ^{3,4} Advance Mark 7® electronic dimming ballast. Minimum dimming level 5%	
	2/18TRT				
	2/26TRT ¹				
2/32TRT					

NOTES

ORDERING NOTES	
1. Will also operate 26DTT 4-PIN lamp.	5. For dimensional changes, refer to TECH-140 .
2. Multi-volt electronic ballast capable of operating on any voltage from 120V through 277V, 50 or 60 Hz.	6. Not available with emergency options.
3. Not available with 347V.	
4. Not available with MVOLT.	

8" LGFLP

Non-Conductive Shower Light

Lensed Low Profile, Triple-Tube Lamp



DIMENSIONAL DATA

All dimensions are inches (centimeters) unless otherwise noted.

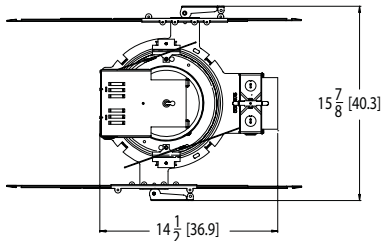

Aperture: 7-7/8 (20.1)
Ceiling Opening: 8-7/8 (22.5)
Overlap Trim: 9-7/16 (24.0)

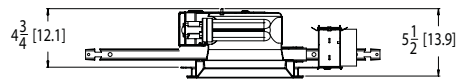

LGFLP 8DFR

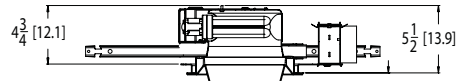

LGFLP 8DFD 15/16 [2.3]

Distribution Curve Distribution Data Output Data Coefficient of Utilization Illuminance: Single Luminaire 30" Above Floor

LGFLP 2/32TRT 8DFR (2) CF32TRT LAMPS, 1.2 S/MH, 2400 RATED LUMENS PER LAMP, TEST NO. LTL20072

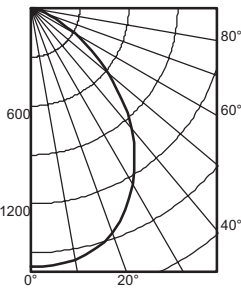

Ave Lumens	Zone Lumens	% Lamp	pf pc pw	20%									
				80%		70%		50%					
				50%	30%	10%	50%	30%	10%	50%	30%	10%	
0	1588			0	80	80	80	78	78	78	74	74	74
5	1583	151	0° - 30°	1	72	69	67	70	68	66	67	66	64
15	1530	430	0° - 40°	2	64	60	57	63	59	56	61	58	55
25	1366	627	0° - 60°	3	57	53	49	56	52	49	54	51	48
35	1112	693	0° - 90°	4	52	47	43	51	46	42	49	45	42
45	786	604	90° - 180°	5	47	41	38	46	41	37	45	40	37
55	447	402	0° - 180°	6	43	37	33	42	37	33	41	36	33
65	204	207		7	39	34	30	38	33	30	37	33	30
75	75	82		8	36	31	27	35	30	27	35	30	27
85	10	14		9	33	28	25	33	28	25	32	28	24
90	0			10	31	26	22	30	26	22	30	25	22

Mounting Height	Initial Center Beam	50% beam - 60.8°		10% beam - 100.3°	
		Diameter	FC	Diameter	FC
8.0	52.5	6.5	26.2	13.2	5.2
10.0	28.2	8.8	14.1	18.0	2.8
12.0	17.6	11.1	8.8	22.8	1.8
14.0	12.0	13.5	6.0	27.6	1.2
16.0	8.7	15.8	4.4	32.4	0.9

LGFLP 2/26TRT 8DFR (2) CF26TRT LAMPS, 1.2 S/MH, 1800 RATED LUMENS PER LAMP, TEST NO. LTL20073

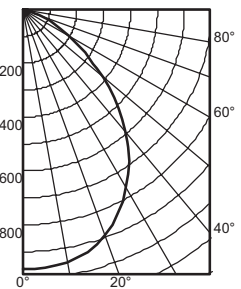

Ave Lumens	Zone Lumens	% Lamp	pf pc pw	20%									
				80%		70%		50%					
				50%	30%	10%	50%	30%	10%	50%	30%	10%	
0	966			0	66	66	66	64	64	64	61	61	61
5	964	92	0° - 30°	1	59	57	55	58	56	54	55	54	53
15	932	262	0° - 40°	2	53	50	47	52	49	46	50	47	45
25	836	384	0° - 60°	3	47	43	40	46	43	40	45	42	39
35	686	428	0° - 90°	4	42	38	35	42	38	35	40	37	34
45	490	376	90° - 180°	5	38	34	31	38	34	31	37	33	30
55	280	252	0° - 180°	6	35	31	27	34	30	27	34	30	27
65	128	129		7	32	28	25	32	27	24	31	27	24
75	47	51		8	29	25	22	29	25	22	28	25	22
85	6	9		9	27	23	20	27	23	20	26	23	20
90	0			10	25	21	18	25	21	18	24	21	18

Mounting Height	Initial Center Beam	50% beam - 61.2°		10% beam - 100.8°	
		Diameter	FC	Diameter	FC
8.0	31.9	6.5	16.0	13.3	3.2
10.0	17.2	8.9	8.6	18.1	1.7
12.0	10.7	11.2	5.4	23.0	1.1
14.0	7.3	13.6	3.7	27.8	0.7
16.0	5.3	16.0	2.6	32.6	0.5

LGFLP 2/32TRT 8DFD (2) CF32TRT LAMPS, 1.1 S/MH, 2400 RATED LUMENS PER LAMP, TEST NO. LTL20075

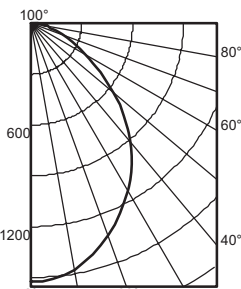

Ave Lumens	Zone Lumens	% Lamp	pf pc pw	20%									
				80%		70%		50%					
				50%	30%	10%	50%	30%	10%	50%	30%	10%	
0	1526			0	82	82	82	80	80	80	77	77	77
5	1514	143	0° - 30°	1	73	70	68	71	69	67	68	66	64
15	1411	397	0° - 40°	2	64	60	56	63	59	56	61	57	54
25	1237	570	0° - 60°	3	57	52	48	56	51	47	54	50	47
35	1033	644	0° - 90°	4	51	46	41	50	45	41	49	44	40
45	778	599	90° - 120°	5	46	40	36	45	40	36	44	39	35
55	501	450	90° - 130°	6	42	36	32	41	36	32	40	35	31
65	282	283	90° - 150°	7	38	32	28	38	32	28	37	32	28
75	145	156	90° - 180°	8	35	29	26	35	29	26	34	29	25
85	62	69	0° - 180°	9	32	27	23	32	27	23	31	26	23
90	30			10	30	25	21	30	25	21	29	24	21

Mounting Height	Initial Center Beam	50% beam - 58.7°		10% beam - 101.9°	
		Diameter	FC	Diameter	FC
8.0	50.4	6.2	25.2	13.6	5.0
10.0	27.1	8.4	13.6	18.5	2.7
12.0	16.9	10.7	8.5	23.4	1.7
14.0	11.5	12.9	5.8	28.4	1.2
16.0	8.4	15.2	4.2	33.3	0.8

PHOTOMETRY NOTES

- Tested to current IES and NEMA standards under stabilized laboratory conditions.
- Actual performance may differ as a result of end-user environment and application.
- Consult factory or IES file for microgroove baffle, black cone or other photometric reports.