

Gotham Architectural Downlighting  
Compact Fluorescent Downlights

**10" LGF**  
**Round Lens**

Wet Location  
Horizontal Triple-Tube Lamp



FEATURES

**OPTICAL SYSTEM**

- Aluminum upper reflector coated with highly reflective white paint provides high efficiency and an evenly illuminated aperture appearance.
- Available with tempered prismatic lens (T73), flat Fresnel lens (FFL) or flat opal lens (FOL).
- Regressed white door (RW) or stepped black baffle (SB) are available with white painted flange provided.
- Door is retained by self-aligning, torsion support springs, preventing gaps between door and ceiling.

**MECHANICAL SYSTEM**

- 16-gauge galvanized steel mounting/plaster frame with integral yoke to retain optical system. Maximum 1-1/4" ceiling thickness.
- 16-gauge galvanized steel mounting bars with continuous 4" vertical adjustment are shipped pre-installed. Post installation adjustment possible without the use of tools from above or below ceiling.
- Galvanized steel junction box with hinged access covers and spring latch. Two combination 1/2"-3/4" and three 1/2" knockouts for straight-through conduit runs. Capacity: 8 (4 in, 4 out) No. 12 AWG conductors, rated for 90°C.

**ELECTRICAL SYSTEM**

- Galvanized steel lampholder housing.
- Horizontally-mounted, four-pin, positive-latch, thermoplastic socket(s).
- Class P, thermally-protected, high power factor, electronic ballast(s) mounted to the junction box.

**LISTING**

- Fixtures are UL Listed for thru-branch wiring, non-IC recessed mounting and wet locations. Listed and labeled to comply with Canadian standards.

**WARRANTY**

- 1-year limited warranty. Complete warranty terms located at: [www.acuitybrands.com/CustomerResources/Terms\\_and\\_conditions.aspx](http://www.acuitybrands.com/CustomerResources/Terms_and_conditions.aspx)

ORDERING INFORMATION

**EXAMPLE: LGF 2/26TRT 10RW T73 MVOLT**

Series	Number of lamps/	Wattage/Lamp	Door frame	Lens type	Voltage	Ballast
LGF	1	18TRT	10RW Regressed white door	FFL Flat fresnel lens	MVOLT <sup>3</sup>	ECOS <sup>5</sup> EcoSystem electronic dimming ballast. Minimum dimming level 5%.
	2	26TRT <sup>1</sup>		FOL Flat opal lens	120	ADEZ <sup>4,6</sup> Advance Mark X <sup>®</sup> electronic dimming ballast. Minimum dimming level 5%
	3	32TRT 42TRT 57TRT <sup>2</sup>	10SB Stepped black baffle		277 347	

Options

<b>CP</b> Chicago plenum	<b>RIF</b> Radio interference filter
<b>TRDA<sup>7</sup></b> Tamper resistant door assembly	<b>QDS<sup>10</sup></b> Quick Disconnect System for easy ballast replacement
<b>RRL<sup>6,8,9</sup></b> RELOC <sup>®</sup> -ready luminaire. Provides compatibility with Lithonia RELOC system. Access above ceiling required.	<b>ELR<sup>11</sup></b> Emergency battery pack. Remote test switch provided
<b>DS</b> Dual Switching	<b>ELRSD<sup>11</sup></b> High lumen output emergency battery pack. Remote test switch and self-diagnostics module provided
<b>GMF</b> Single, slow-blow fuse (not available with MVOLT)	<b>GSKT</b> Foam gasketing ships uninstalled
<b>GLR</b> Single, fast-blow fuse (not available with MVOLT)	<b>NPP16D EFP</b> nLight network power/relay pack with 0-10V dimming.
<b>WLP</b> Lamp (shipped separately)	<b>NPP16D ER EFP</b> nLight network power/relay pack with 0-10V dimming. ER controls fixtures on emergency circuit.

ACCESSORIES order as separate catalog numbers (shipped separately)

**SCA10** Sloped ceiling adapter. Degree of slope must be specified (10D, 15D, 20D, 25D, 30D). Ex: SCA10 10D.

# 10" LGF

## Round Lens

Wet Location, Horizontal Triple-Tube Lamp



DIMENSIONAL DATA

All dimensions are inches (centimeters) unless otherwise noted.

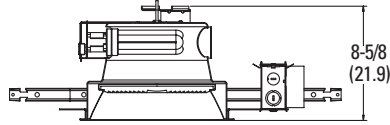
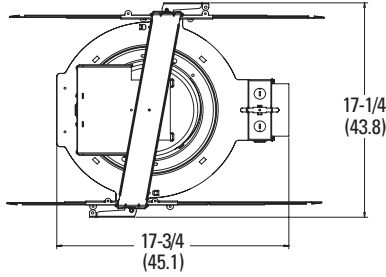

- Aperture: 9-3/4 (24.8)
- Ceiling Opening: 10-1/2 (26.7)
- Overlap Trim: 11-1/8 (28.3)

NOTES

### ORDERING NOTES

- 1. Will also operate 26DTT 4-PIN lamp.
- 2. Not available in 3 lamp configurations.
- 3. Multi-volt electronic ballast capable of operating on any voltage from 120V through 277V, 50 or 60 Hz.
- 4. Not available with MVOLT.
- 5. 2/242TRT Option only available with DS (Dual Switching) option.
- 6. Not available with 347V.
- 7. Uses Torx T15 rejection pin drive system.
- 8. Not available with 57TRT.
- 9. For compatible RELOC systems, refer to [TECH-110](#).
- 10. Not available with ELR option.
- 11. For dimensional changes refer to [TECH-140](#). For 57W and 70W consult factory.



Distribution Curve    Distribution Data    Output Data    Coefficient of Utilization    Illuminance: Single Luminaire 30" Above Floor

**LGF 2/42TRT 10RW T73**

42TRT LAMP, 1.1 S/MH, 3200 RATED LUMENS, TEST NO. LTL14196

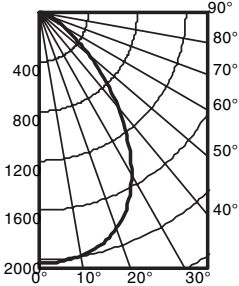

From 0°	Ave	Lumens	Zone	Lumens	% Lamp	pf	20%			50%			50% beam angle			10% beam angle				
0°			0° - 30°			pc	70%			50%			58.9°			94.2°				
						pw	50%	30%	50%	30%	50%	30%	50%	30%	Initial fc	fc at	Beam	Beam	fc at	
							height	center	diameter	edge	diameter	edge	diameter	edge	Mount at beam	beam	Beam	beam	fc at	
															height	center	diameter	edge	diameter	edge
0	2026		0° - 30°	1521.9	23.8	1	.58	.56	.57	.55	.55	.53	8	67.0	6.2	33.5	11.8	6.7		
5	2022	192	0° - 40°	2305.9	36.0	2	.52	.50	.51	.49	.50	.47	10	36.0	8.5	18.0	16.2	3.6		
15	1946	547	0° - 60°	3204.0	50.1	3	.47	.44	.47	.43	.45	.42	12	22.4	10.7	11.2	20.5	2.2		
25	1712	782	0° - 90°	3443.0	53.8	4	.43	.39	.42	.39	.41	.38	14	15.3	13.0	7.7	24.8	1.5		
35	1261	784	90° - 180°	0.0	0.0	5	.39	.35	.39	.35	.38	.34	16	11.1	15.3	5.6	29.1	1.1		
45	744	575	0° - 180°	3443.0	*53.8	6	.36	.32	.36	.32	.35	.31								
55	353	323																		
65	160	161																		
75	55	62																		
85	13	15																		
90	0																			

**LGF 2/42TRT 10RW FFL**

42TRT LAMP, 1.1 S/MH, 3200 RATED LUMENS, TEST NO. LTL14197

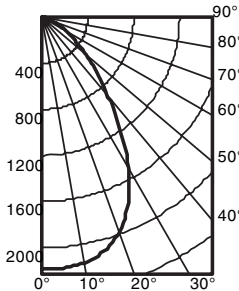

From 0°	Ave	Lumens	Zone	Lumens	% Lamp	pf	20%			50%			50% beam angle			10% beam angle				
0°			0° - 30°			pc	70%			50%			56.8°			91.7°				
						pw	50%	30%	50%	30%	50%	30%	50%	30%	Initial fc	fc at	Beam	Beam	fc at	
							height	center	diameter	edge	diameter	edge	diameter	edge	Mount at beam	beam	Beam	beam	fc at	
															height	center	diameter	edge	diameter	edge
0	2183		0° - 30°	1608.2	25.1	1	.58	.57	.57	.56	.55	.54	8	72.2	5.9	36.1	11.3	7.2		
5	2184	208	0° - 40°	2353.3	36.8	2	.53	.50	.52	.49	.50	.48	10	38.8	8.1	19.4	15.5	3.9		
15	2101	589	0° - 60°	3212.3	50.2	3	.48	.44	.47	.44	.46	.43	12	24.2	10.3	12.1	19.6	2.4		
25	1780	811	0° - 90°	3461.3	54.1	4	.44	.40	.43	.39	.42	.38	14	16.5	12.4	8.3	23.7	1.7		
35	1195	745	90° - 180°	0.0	0.0	5	.40	.36	.39	.35	.38	.35	16	12.0	14.6	6.0	27.8	1.2		
45	677	527	0° - 180°	3461.3	*54.1	6	.37	.32	.36	.32	.35	.32								
55	366	332																		
65	169	170																		
75	56	63																		
85	13	15																		
90	0																			

**LGF 3/42TRT 10RW T73**

42TRT LAMP, 1.1 S/MH, 3200 RATED LUMENS, TEST NO. LTL14214

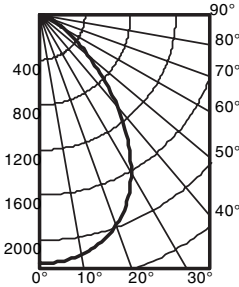

From 0°	Ave	Lumens	Zone	Lumens	% Lamp	pf	20%			50%			50% beam angle			10% beam angle				
0°			0° - 30°			pc	70%			50%			58.2°			93.9°				
						pw	50%	30%	50%	30%	50%	30%	50%	30%	Initial fc	fc at	Beam	Beam	fc at	
							height	center	diameter	edge	diameter	edge	diameter	edge	Mount at beam	beam	Beam	beam	fc at	
															height	center	diameter	edge	diameter	edge
0	2203		0° - 30°	1628.3	17.0	1	.41	.40	.40	.39	.39	.38	8	72.8	6.1	36.4	11.8	7.3		
5	2194	208	0° - 40°	2466.4	25.7	2	.37	.35	.37	.35	.35	.34	10	39.2	8.4	19.6	16.1	3.9		
15	2086	587	0° - 60°	3421.4	35.6	3	.34	.31	.33	.31	.32	.30	12	24.4	10.6	12.2	20.3	2.4		
25	1823	834	0° - 90°	3674.0	38.3	4	.31	.28	.30	.28	.29	.27	14	16.7	12.8	8.3	24.6	1.7		
35	1350	838	90° - 180°	0.0	0.0	5	.28	.25	.28	.25	.27	.24	16	12.1	15.0	6.0	28.9	1.2		
45	791	612	0° - 180°	3674.0	*38.3	6	.26	.23	.25	.23	.25	.22								
55	376	343																		
65	169	171																		
75	57	66																		
85	14	16																		
90	0																			

**LGF 3/42TRT 10RW FFL**

42TRT LAMP, 1.1 S/MH, 3200 RATED LUMENS, TEST NO. LTL14215

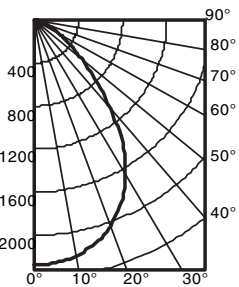

From 0°	Ave	Lumens	Zone	Lumens	% Lamp	pf	20%			50%			50% beam angle			10% beam angle				
0°			0° - 30°			pc	70%			50%			58.0°			93.3°				
						pw	50%	30%	50%	30%	50%	30%	50%	30%	Initial fc	fc at	Beam	Beam	fc at	
							height	center	diameter	edge	diameter	edge	diameter	edge	Mount at beam	beam	Beam	beam	fc at	
															height	center	diameter	edge	diameter	edge
0	2275		0° - 30°	1673.5	17.4	1	.42	.41	.42	.40	.40	.39	8	75.2	6.1	37.6	11.7	7.5		
5	2265	215	0° - 40°	2533.1	26.4	2	.38	.36	.38	.36	.36	.35	10	40.4	8.3	20.2	15.9	4.0		
15	2148	604	0° - 60°	3503.3	36.5	3	.35	.32	.34	.32	.33	.31	12	25.2	10.5	12.6	20.1	2.5		
25	1868	855	0° - 90°	3773.0	39.3	4	.31	.29	.31	.28	.30	.28	14	17.2	12.8	8.6	24.4	1.7		
35	1392	860	90° - 180°	0.0	0.0	5	.29	.26	.28	.26	.28	.25	16	12.5	15.0	6.2	28.6	1.2		
45	783	610	0° - 180°	3773.0	*39.3	6	.26	.23	.26	.23	.25	.23								
55	396	360																		
65	183	184																		
75	61	69																		
85	15	17																		
90	0																			

PHOTOMETRY NOTES

- Tested to current IES and NEMA standards under stabilized laboratory conditions.
- Actual performance may differ as a result of end-user environment and application.
- Consult factory or IES file for microgroove baffle, black cone or other photometric reports.