

Gotham Architectural Downlighting
Compact Fluorescent Downlights

6" LGF
Round Lens

Wet Location
Horizontal Triple-Tube Lamp



FEATURES

OPTICAL SYSTEM

- Aluminum upper reflector coated with highly reflective white paint provides high efficiency and an evenly illuminated aperture appearance.
- Available with tempered prismatic lens (T73), flat Fresnel lens (FFL) or flat opal lens (FOL).
- Regressed white door (RW) or stepped black baffle (SB) are available with white painted flange provided.
- Door is retained by self-aligning, torsion support springs, preventing gaps between door and ceiling.

MECHANICAL SYSTEM

- 16-gauge galvanized steel mounting/plaster frame with integral yoke to retain optical system. Maximum 1-1/2" ceiling thickness.
- 16-gauge galvanized steel mounting bars with continuous 4" vertical adjustment are shipped pre-installed. Post installation adjustment possible without the use of tools from above or below ceiling.
- Galvanized steel junction box with hinged access covers and spring latch. Two combination 1/2"-3/4" and three 1/2" knockouts for straight-through conduit runs. Capacity: 8 (4 in, 4 out) No. 12 AWG conductors, rated for 90°C.

ELECTRICAL SYSTEM

- Galvanized steel lampholder housing.
- Horizontally-mounted, four-pin, positive-latch, thermoplastic socket.
- Class P, thermally-protected, high power factor, electronic ballast mounted to the junction box.

LISTING

- Fixtures are UL Listed for thru-branch wiring, non-IC recessed mounting and wet locations. Listed and labeled to comply with Canadian standards.

WARRANTY

- 1-year limited warranty. Complete warranty terms located at: www.acuitybrands.com/CustomerResources/Terms_and_conditions.aspx

ORDERING INFORMATION

EXAMPLE: LGF 1/26TRT 6RW T73 MVOLT

Series	Wattage/Lamp	Door frame	Lens type	Voltage	Ballast
LGF	1/18TRT	6RW Regressed white door	FFL Flat fresnel lens	MVOLT ²	(blank) Electronic ballast (standard)
	1/26TRT ¹	6SB Stepped black baffle	FOL Flat opal lens	120	ECOS EcoSystem electronic dimming ballast. Minimum dimming level 5%.
	1/32TRT		PPC Prismatic polycarbonate lens	277	ADEZ ^{3,4} Advance Mark X [®] electronic dimming ballast. Minimum dimming level 5%
	1/42TRT			347	ADZT ⁴ Advance Mark VII [™] electronic dimming ballast

Options

CP	Chicago plenum	RIF	Radio interference filter
TRDA⁵	Tamper resistant door assembly	QDS⁷	Quick Disconnect System for easy ballast replacement
RRL⁶	RELOC [®] -ready luminaire. Provides compatibility with Lithonia RELOC system. Access above ceiling required.	ELR⁸	Emergency battery pack. Remote test switch
GMF	Single, slow-blow fuse (not available with MVOLT)	ELRSD⁸	High lumen output emergency battery pack. Remote test switch provided
GLR	Single, fast-blow fuse (not available with MVOLT)	GSKT	Foam gasketing ships uninstalled
WLP	Lamp (shipped separately)	NPP16D EFP	nLight network power/relay pack with 0-10V dimming.
		NPP16D ER EFP	nLight network power/relay pack with 0-10V dimming. ER controls fixtures on emergency circuit.

ACCESSORIES order as separate catalog numbers (shipped separately)

SCA6 Sloped ceiling adapter. Degree of slope must be specified (10D, 15D, 20D, 25D, 30D). Ex: SCA6 10D.

6" LGF

Round Lens

Wet Location, Horizontal Triple-Tube Lamp



DIMENSIONAL DATA

All dimensions are inches (centimeters) unless otherwise noted.

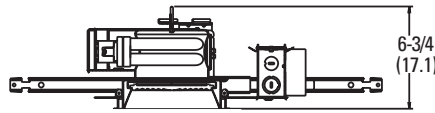
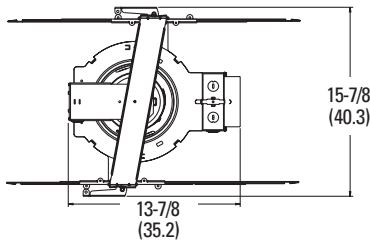

Aperture: 6-1/4 (15.9)
 Ceiling Opening: 7-1/8 (18.1)
 Overlap Trim: 7-1/2 (19.1)

ELECTRICAL

Energy (Calculated in accordance with NEMA standard LE-5A)						
LER	DOL	Annual Energy Cost	Lamps	Lamp Lumens	Ballast Factor	Input Watts
28	\$	8.71	(1) 26W DTT	1825	1.00	26.5
29	\$	8.41	(1) 26W TRT	1800	1.00	29
40	\$	6.06	(1) 32W TRT	2400	0.98	31.5
25	\$	9.47	(1) 42W TRT	3200	1.00	48

NOTES

ORDERING NOTES	
1. Will also operate 26DTT 4-PIN lamp.	5. Uses Torx T20 rejection pin drive system. You may order RK1 T20DRV U Torx driver accessory.
2. Multi-volt electronic ballast capable of operating on any voltage from 120V through 277V, 50 or 60 Hz.	6. For compatible RELOC systems, refer to TECH-110 .
3. Not available with MVOLT.	7. Not available with ELR or ELRSD option.
4. Not available with 347V.	8. For dimensional changes refer to TECH-140 .



Distribution Curve Distribution Data Output Data Coefficient of Utilization Illuminance: Single Luminaire 30" Above Floor

LGF 1/32TRT 6RW T73 32TRT LAMP, 1.1 S/MH, 2400 RATED LUMENS, TEST NO. LTL14212

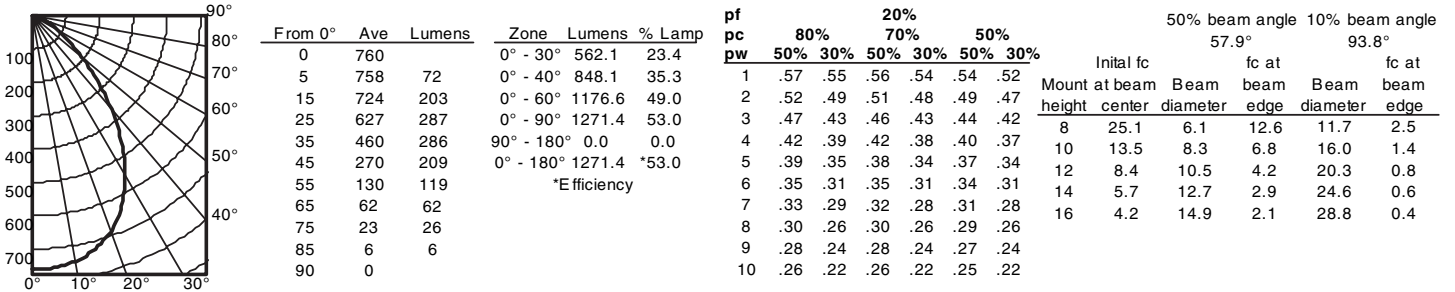

LGF 1/32TRT 6RW FFL 32TRT LAMP, 1.1 S/MH, 2400 RATED LUMENS, TEST NO. LTL14213

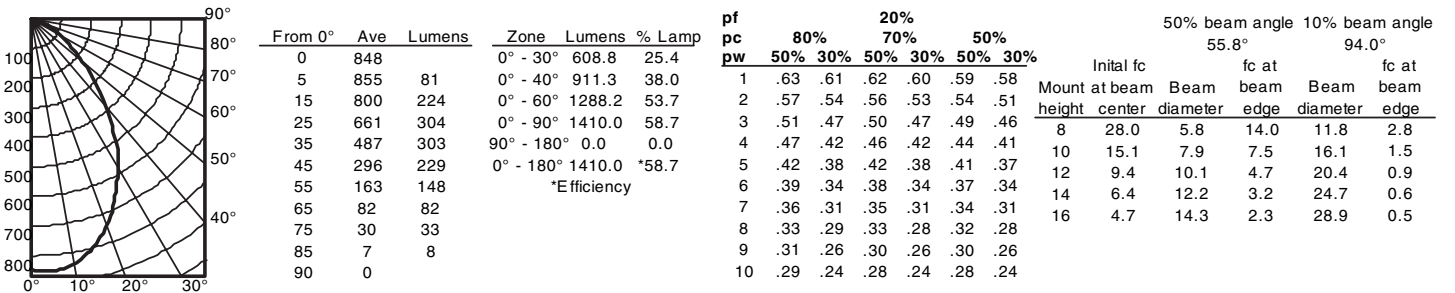

PHOTOMETRY NOTES

- Tested to current IES and NEMA standards under stabilized laboratory conditions.
- Actual performance may differ as a result of end-user environment and application.
- Consult factory or IES file for microgroove baffle, black cone or other photometric reports.