



Gotham Architectural Downlighting
International Incandescent Downlights/Wallwash

AII/AWI
15.2cm (6") Open/Wallwash Reflector

FEATURES

OPTICAL SYSTEM

- Reflector: Self-flanged, semi-specular or matte-diffuse reflector. Patented Bounding Ray™ Optical Principle design (U.S. Patent No. 5,800,050) provides lamp before lamp image and smooth transition from top of reflector to bottom. Minimum flange matches reflector finish.
- Wallwash: Highly reflective outer kicker reflector provides smooth, uniform illumination floor to ceiling, edge to edge. Inner cone is contoured to eliminate room side flash. For optimal uniformity, the recommended luminaire spacing is 0.9m (3') from the wall and 0.9m (3') centers.

MECHANICAL SYSTEM

- Galvanized steel junction box is mounted to reflector with hinge mechanism. Knockouts provided for power supply feed. No. 12 AWG conductors, rated for 90°C.
- Three (3) swinggate brackets allow for installation from below the ceiling. Suitable for ceiling thickness ranging from 1.59cm (5/8") to 2.54cm (1").

ELECTRICAL SYSTEM

- Die-cast aluminum lampholder housing.
- Medium-base porcelain socket with nickelplated screw shell.
- Eurostyle terminal block included for power supply and ground connections required for CE.

LISTING

- 120V fixtures are UL Listed, Non-IC recessed mounting and damp locations. 240V fixtures are CE certified and rated IP20.

WARRANTY

- 1-year limited warranty. Complete warranty terms located at: www.acuitybrands.com/CustomerResources/Terms_and_conditions.aspx

ORDERING INFORMATION

EXAMPLE: AII 6AR 120

Series ¹	Aperture/Trim color	Finish	Lens type ³	Voltage	Options
AII	6AR Clear	(blank) Semi-specular	(blank) No lens	120 UL Listed	SF Single fuse
AWI	6PR Pewter	LD Matte-diffuse	CGL Clear glass lens	240 CE Certified	TRW⁴ White painted flange
	6WTR Wheat	LS Specular	T73 Tempered prismatic lens		TRBL Black painted flange
	6GR Gold				GSKT Foam gasketing
	6WC^{2,3} White painted				
	6BC^{2,3} Black Cone				

NOTES

ORDERING NOTES
<ol style="list-style-type: none"> 1. Maximum wattage: 150W. 2. Not available with finishes. 3. AII only. 4. Standard on 6WC.

DIMENSIONAL DATA

All dimensions are inches (centimeters) unless otherwise noted.

ULLISTED

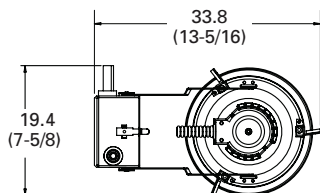

CE CERTIFIED

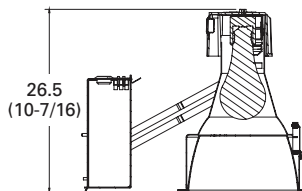
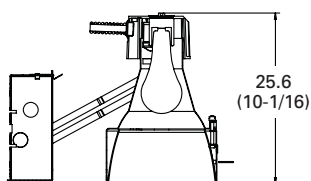
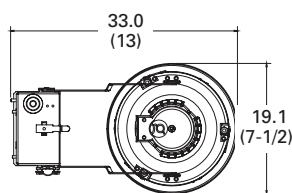

Aperture: 15.9 (6-1/4)
Ceiling opening: 17.5 (6-7/8)
Overlap trim: 19.1 (7-1/2)

ELECTRICAL

ENERGY (Calculated in accordance with NEMA standard LE-5A)						
LER.DOL	Annual* Energy Cost	Lamps	Lamp Lumens	Ballast Factor	Input Watts	
12	\$20.67	(1) 100W A19	1710	N/A	100	
13	\$18.58	(1) 150W A21	2850	N/A	150	

*Comparative yearly lighting energy cost per 1000 lumens

Distribution Curve Distribution Data Output Data Coefficient of Utilization Illuminance: Single Luminaire 30" Above Floor

AII 6AR (100 A19) (1) 100A LAMP, 1750 RATED LUMENS, 1.3 S/MH, TEST NO. LTL7258

Angle	Ave Lumens			Zone Lumens % Lamp			pf pc pw	80%			20%			50%			50% beam 65.7°	10% beam 87.4°
	Ave	Lumens	% Lamp	Lumens	% Lamp			50%	30%	10%	50%	30%	10%	50%	30%	10%		
0°	801			0° - 30°	696	39.8	0	81	81	81	79	79	79	75	75	75		
5°	813	78		0° - 40°	1061	60.6	1	75	73	71	73	72	70	71	69	68		
15°	830	236		0° - 60°	1188	67.9	2	69	66	64	68	65	63	66	64	62		
25°	845	383		0° - 90°	1188	67.9	3	64	60	57	63	60	57	61	58	56		
35°	599	364		90° - 180°	0	0.0	4	59	55	52	58	55	52	57	54	51		
45°	151	124		0° - 180°	1188	67.9	5	55	51	47	54	50	47	53	49	47		
55°	1	2					6	51	46	43	50	46	43	49	46	43		
65°	0	0					7	47	43	40	47	43	40	46	42	39		
75°	0	0					8	44	40	37	44	39	37	43	39	36		
85°	0	0					9	41	37	34	41	37	34	40	36	34		
90°	0	0					10	39	34	31	38	34	31	38	34	31		

Mounting Height	Initial FC Center Beam	50% beam Diameter	10% beam Diameter	FC	FC
8.0	26.5	7.1	13.2	10.5	2.6
10.0	14.2	9.7	7.1	14.3	1.4
12.0	8.9	12.3	4.4	18.2	0.9
14.0	6.1	14.8	3.0	22.0	0.6
16.0	4.4	17.4	2.2	25.8	0.4

AII 6AR (150 A21) (1) 150A LAMP, 2780 RATED LUMENS, 1.2 S/MH, TEST NO. LTL7257

Angle	Ave Lumens			Zone Lumens % Lamp			pf pc pw	80%			20%			50%			50% beam 60.1°	10% beam 84.6°
	Ave	Lumens	% Lamp	Lumens	% Lamp			50%	30%	10%	50%	30%	10%	50%	30%	10%		
0°	1510			0° - 30°	1166	41.9	0	81	81	81	79	79	79	76	76	76		
5°	1541	144		0° - 40°	1702	61.2	1	75	73	72	74	72	71	71	70	68		
15°	1443	409		0° - 60°	1889	67.9	2	69	67	64	68	66	63	66	64	62		
25°	1352	612		0° - 90°	1890	68.0	3	64	61	58	63	60	57	62	59	57		
35°	886	536		90° - 180°	0	0.0	4	60	56	53	59	55	52	57	54	52		
45°	211	178		0° - 180°	1890	68.0	5	55	51	48	55	51	48	54	50	47		
55°	6	9					6	52	47	44	51	47	44	50	46	44		
65°	1	1					7	48	44	41	48	44	41	47	43	40		
75°	0	0					8	45	41	38	45	40	38	44	40	37		
85°	0	0					9	42	38	35	42	38	35	41	37	35		
90°	0	0					10	40	35	33	39	35	32	39	35	32		

Mounting Height	Initial FC Center Beam	50% beam Diameter	10% beam Diameter	FC	FC
8.0	49.9	6.4	25.0	10.0	5.0
10.0	26.8	8.7	13.4	13.6	2.7
12.0	16.7	11.0	8.4	17.3	1.7
14.0	11.4	13.3	5.7	20.9	1.1
16.0	8.3	15.6	4.1	24.6	0.8

AII 6AR GL (100 A19) (1) 100A LAMP, 1750 RATED LUMENS, 1.3 S/MH, TEST NO. LTL7753

Angle	Ave Lumens			Zone Lumens % Lamp			pf pc pw	80%			20%			50%			50% beam 65.6°	10% beam 87.4°
	Ave	Lumens	% Lamp	Lumens	% Lamp			50%	30%	10%	50%	30%	10%	50%	30%	10%		
0°	738			0° - 30°	641	36.6	0	74	74	74	73	73	73	69	69	69		
5°	748	72		0° - 40°	976	55.8	1	69	67	66	67	66	65	65	64	63		
15°	764	217		0° - 60°	1093	62.4	2	64	61	59	63	60	58	60	58	57		
25°	777	352		0° - 90°	1093	62.4	3	59	55	53	58	55	52	56	54	52		
35°	551	335		90° - 180°	0	0.0	4	54	51	48	54	50	48	52	49	47		
45°	139	115		0° - 180°	1093	62.4	5	50	46	44	50	46	43	49	45	43		
55°	1	2					6	47	43	40	46	42	40	45	42	39		
65°	0	0					7	44	39	37	43	39	37	42	39	36		
75°	0	0					8	41	37	34	40	36	34	39	36	33		
85°	0	0					9	38	34	31	38	34	31	37	33	31		
90°	0	0					10	35	32	29	35	31	29	35	31	29		

Mounting Height	Initial FC Center Beam	50% beam Diameter	10% beam Diameter	FC	FC
8.0	24.4	7.1	12.2	10.5	2.4
10.0	13.1	9.7	6.6	14.3	1.3
12.0	8.2	12.3	4.1	18.2	0.8
14.0	5.6	14.8	2.8	22.0	0.6
16.0	4.0	17.4	2.0	25.8	0.4

AII 6AR GL (150 A21) (1) 150A LAMP, 2780 RATED LUMENS, 1.2 S/MH, TEST NO. LTL7756

Angle	Ave Lumens			Zone Lumens % Lamp			pf pc pw	80%			20%			50%			50% beam 63.8°	10% beam 96.4°
	Ave	Lumens	% Lamp	Lumens	% Lamp			50%	30%	10%	50%	30%	10%	50%	30%	10%		
0°	2305			0° - 30°	1932	33.3	0	81	81	81	79	79	79	76	76	76		
5°	2385	231		0° - 40°	2970	51.2	1	75	73	71	73	72	70	70	69	68		
15°	2412	682		0° - 60°	3955	68.2	2	68	65	62	67	64	62	65	62	60		
25°	2236	1019		0° - 90°	3962	68.3	3	63	59	55	62	58	55	60	57	54		
35°	1670	1038		90° - 180°	0	0.0	4	57	53	49	56	52	49	55	51	49		
45°	1002	761		0° - 180°	3962	68.3	5	53	48	44	52	47	44	51	47	44		
55°	204	224					6	48	44	40	48	43	40	47	43	40		
65°	4	5					7	45	40	36	44	40	36	43	39	36		
75°	1	1					8	41	37	33	41	36	33	40	36	33		
85°	1	0					9	38	34	30	38	33	30	37	33	30		
90°	0	0					10	36	31	28	35	31	28	35	31	28		

Mounting Height	Initial FC Center Beam	50% beam Diameter	10% beam Diameter	FC	FC
8.0	76.2	6.8	38.1	12.3	7.6
10.0	41.0	9.3	20.5	16.8	4.1
12.0	25.5	11.8	12.8	21.3	2.6
14.0	17.4	14.3	8.7	25.7	1.7
16.0	12.6	16.8	6.3	30.2	1.3

PHOTOMETRY NOTES

- Tested to current IES and NEMA standards under stabilized laboratory conditions.
- Actual performance may differ as a result of end-user environment and application.
- Consult factory or IES file for microgroove baffle, black cone or other photometric reports.