



Gotham Architectural Downlighting  
Renovation Compact Fluorescent Downlights

**6" LGFVI**  
**Round Lens**

Vertical DTT or TRT Lamp

FEATURES

**OPTICAL SYSTEM**

- Aluminum upper reflector coated with highly reflective white paint provides high efficiency and an evenly illuminated aperture appearance.
- Available with tempered prismatic lens (T73), flat fresnel lens (FFL) or flat opal lens (FOL).
- Regressed white door (RW) or stepped black baffle (SB) are available with white painted flange provided.
- Door is retained by self-aligning, torsion support springs, preventing gaps between door and ceiling.

**MECHANICAL SYSTEM**

- Pre-wired galvanized steel junction box mounted to reflector is provided with removable access cover. No. 12 AWG conductors rated for 90°C.
- Three (3) swinggate brackets allow for installation from below the ceiling. Suitable for ceiling thickness ranging from 5/8" (1.59cm) to 1" (2.54cm).

**ELECTRICAL SYSTEM**

- Rugged aluminum lampholder housing.
- Vertically-mounted, four-pin, positive-latch, thermoplastic socket.

- Thermally protected, high-power-factor electronic ballast (50/60Hz) mounted to the junction box.

**LISTING**

- Fixtures are UL Listed, non-IC recessed mounting and wet locations.

**WARRANTY**

- 1-year limited warranty. Complete warranty terms located at [www.acuitybrands.com/CustomerResources/Terms\\_and\\_conditions.aspx](http://www.acuitybrands.com/CustomerResources/Terms_and_conditions.aspx)

ORDERING INFORMATION

**EXAMPLE: LGFVI 26TRT 6RW T73 MVOLT**

Series	Wattage/Lamp	Aperture/Trim color	Lens type	Voltage	Ballast	Options	
LGFVI	13DTT	6RW	T73	MVOLT <sup>1</sup> 120 277	(blank) Electronic ballast ECOS Lutron EcoSystem® electronic dimming ballast. Minimum dimming level 5%. ADEZ <sup>2</sup> Advance Mark 10® electronic dimming ballast. Minimum dimming level 5%	GMF <sup>2</sup> Single, slow-blow fuse GLR <sup>2</sup> Single, fast-blow fuse GSKT Foam gasketing TRW White painted flange TRBL Black painted flange TRDA Tamper-resistant door assembly WLP With 3500 K lamp (shipped separately)	
	18DTT						Regressed white door
	26DTT	6SB	Stepped black baffle				PPC
	13TRT	6RA	Regressed anodized				
	18TRT						
	26TRT						
	32TRT						
	42TRT						

NOTES

**ORDERING NOTES**

1. Multi-volt electronic ballast capable of operating on any line voltage from 120V through 277V, 50 or 60 Hz.
2. Available in 120V or 277V only.

DIMENSIONAL DATA

All dimensions are inches (centimeters) unless otherwise noted.

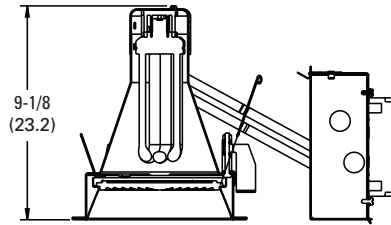
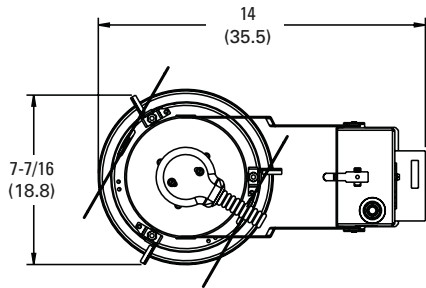

Aperture: 6-1/4 (15.9)  
Ceiling Opening: 6-5/8 (16.8)  
Overlap Trim: 7-1/2 (19.1)

Distribution Curve    Distribution Data    Output Data    Coefficient of Utilization    Illuminance: Single Luminaire 30" Above Floor

**LGFVI 32TRT 6RW T73**

32TRT LAMP, 1.1 S/MH, 2400 RATED LUMENS, TEST NO. LTL14208

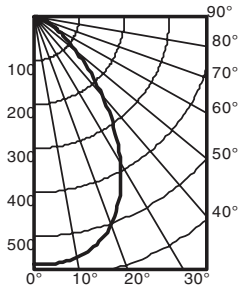

From 0°	Ave Lumens	Zone Lumens	% Lamp	pf pc	20%				50% beam angle		10% beam angle	
					80%	70%	50%	30%	50%	30%	56.1°	91.2°
pw	50%	30%	50%	30%	50%	30%	Initial fc	fc at	fc at	fc at	fc at	
Mount	at beam	Beam	beam	beam	Beam	beam	height	center	diameter	edge	diameter	edge
1	.39	.38	.39	.37	.37	.36	8	18.6	5.9	9.3	11.2	1.9
2	.36	.34	.35	.33	.34	.32	10	10.0	8.0	5.0	15.3	1.0
3	.32	.30	.32	.30	.31	.29	12	6.2	10.1	3.1	19.4	0.6
4	.29	.27	.29	.27	.28	.26	14	4.3	12.3	2.1	23.5	0.4
5	.27	.24	.26	.24	.26	.24	16	3.1	14.4	1.5	27.6	0.3
6	.25	.22	.24	.22	.24	.21						
7	.23	.20	.23	.20	.22	.20						
8	.21	.18	.21	.18	.20	.18						
9	.20	.17	.19	.17	.19	.17						
10	.18	.16	.18	.16	.18	.16						

**LGFVI 32TRT 6RW FFL**

32TRT LAMP, 1.1 S/MH, 2400 RATED LUMENS, TEST NO. LTL14209

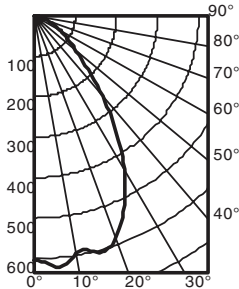

From 0°	Ave Lumens	Zone Lumens	% Lamp	pf pc	20%				50% beam angle		10% beam angle	
					80%	70%	50%	30%	50%	30%	58.1°	91.3°
pw	50%	30%	50%	30%	50%	30%	Initial fc	fc at	fc at	fc at	fc at	
Mount	at beam	Beam	beam	beam	Beam	beam	height	center	diameter	edge	diameter	edge
1	.45	.43	.44	.43	.42	.41	8	20.0	6.1	10.0	11.3	2.0
2	.40	.38	.40	.38	.38	.37	10	10.7	8.3	5.4	15.3	1.1
3	.37	.34	.36	.33	.35	.33	12	6.7	10.6	3.3	19.4	0.7
4	.33	.30	.33	.30	.32	.29	14	4.6	12.8	2.3	23.5	0.5
5	.30	.27	.30	.27	.29	.27	16	3.3	15.0	1.7	27.6	0.3
6	.28	.25	.28	.25	.27	.24						
7	.26	.23	.25	.23	.25	.22						
8	.24	.21	.24	.21	.23	.20						
9	.22	.19	.22	.19	.22	.19						
10	.21	.18	.21	.18	.20	.18						

PHOTOMETRY NOTES

- Tested to current IES and NEMA standards under stabilized laboratory conditions.
- Actual performance may differ as a result of end-user environment and application.
- Consult factory or IES file for microgroove baffle, black cone or other photometric reports.