



Gotham Architectural Downlighting
Renovation Decorative Compact Fluorescent Downlights

8" PDXFI
Ice™ Blade

Horizontal Lamp, Triple-Tube

FEATURES

OPTICAL SYSTEM

- Reflector - Self-flanged, matte-finished clear reflector. Fluted vertical upper section works in conjunction with patented Bounding Ray™ Optical Principle design (U.S. Patent No. 5,800,050) to provide lamp before lamp image and smooth transition from top of reflector to bottom. Minimum flange matches reflector finish. White painted flange optional.
- Cross Baffle - Clear acrylic cross baffle with surface that provides a decorative edge-glow appearance.
- Hinged lampdoor provided for optimal fixture efficiency and the reduction of stray light in the plenum.

MECHANICAL

- Pre-wired galvanized steel junction box mounted to reflector is provided with removable access cover. No. 12 AWG conductors rated for 90°C.
- Three (3) swinggate brackets allow for installation from below the ceiling. Suitable for ceiling thickness ranging from 5/8" (1.59cm) to 1" (2.54cm).

ELECTRICAL SYSTEM

- Horizontally-mounted, positive-latch, thermoplastic socket(s).
- Thermally protected, high power factor electronic ballast (50/60Hz) mounted to the junction box.

LISTING

- Fixtures are UL Listed, non-IC recessed mounting and damp locations.

WARRANTY

- 1-year limited warranty. Complete warranty terms located at: www.acuitybrands.com/CustomerResources/Terms_and_conditions.aspx

ORDERING INFORMATION

EXAMPLE: PDXFI 1/32TRT 8AR CLRFLRVOLT

Series	Lamp/Wattage	Trim color	Baffle type	Voltage	Ballast	Options
PDXFI	1/18TRT	8AR Clear	CLRF Clear flush CLRR Clear round CLRA Clear angular	MVOLT¹	(blank) Electronic ballast	TRW White painted flange WLP With 3500 K lamp (shipped separately) GMF² Single, slow-blow fuse GLR² Single, fast-blow fuse GSKT Foam gasketing, ships uninstalled
	1/26TRT			120		
	1/32TRT			277	ECOS Lutron EcoSystem® electronic dimming ballast. Minimum dimming level 5%.	
	1/42TRT					
	2/18TRT					
	2/26TRT					
	2/32TRT					
	2/42TRT					

NOTES

ORDERING NOTES

1. Multi-volt electronic ballast capable of operating on any line voltage from 120V through 277V, 50 or 60Hz.
2. Available in 120V or 277V only.

DIMENSIONAL DATA

All dimensions are inches (centimeters) unless otherwise noted.

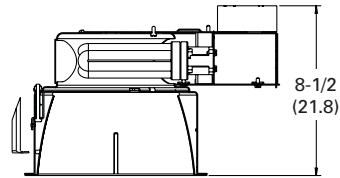
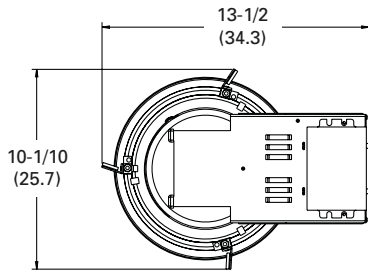

Aperture: 7-7/8 (20.0)
Ceiling Opening: 8-5/8 (21.9)
Overlap Trim: 9-1/4 (23.5)

Distribution Curve Distribution Data Output Data Coefficient of Utilization Illuminance: Single Luminaire 30" Above Floor

PDXFI 1/42TRT 8AR CLRf

(1) CF42DT/E/IN/835, 3200 lumens per lamp, test no. LTL11023

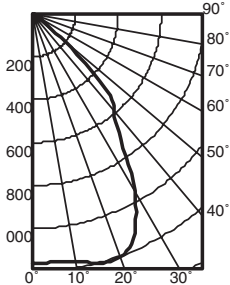

From 0°	Ave	Lumens	Zone	Lumens	% Lamp	pf	Coefficient of Utilization						Illuminance					
							80%		20%		50%		50% beam angle		10% beam angle			
							50%	30%	50%	30%	50%	30%	61.4°	fc at beam edge	Beam diameter	fc at beam edge	Beam diameter	
0	1164		0° - 30°	959.2	30.0	1	.62	.61	.61	.60	.59	.58	Mount height	Initial fc at beam center	Beam diameter	fc at beam edge	Beam diameter	fc at beam edge
5	1160	111	0° - 40°	1418.4	44.3	2	.57	.55	.56	.54	.54	.52	8	38.5	6.5	19.2	11.5	3.9
15	1202	340	0° - 60°	1797.8	56.2	3	.52	.49	.52	.49	.50	.48	10	20.7	8.9	10.3	15.7	2.1
25	1124	508	0° - 90°	1827.1	57.1	4	.48	.45	.48	.44	.46	.43	12	12.9	11.3	6.4	19.9	1.3
35	719	459	90° - 180°	0.0	0.0	5	.44	.41	.44	.40	.43	.40	14	8.8	13.7	4.4	24.1	0.9
45	443	316	0° - 180°	1827.1	*57.1	6	.41	.37	.41	.37	.40	.36	16	6.4	16.0	3.2	28.3	0.6
55	56	64																
65	19	19																
75	8	8																
85	1	2																
90	0																	

PDXFI 2/32TRT 8AR CLRf

(2) CF32DT/E/IN/835, 2400 lumens per lamp, test no. LTL11025

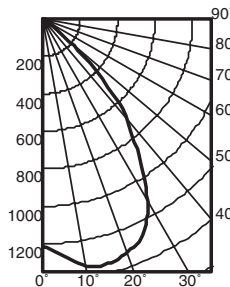

From 0°	Ave	Lumens	Zone	Lumens	% Lamp	pf	Coefficient of Utilization						Illuminance					
							80%		20%		50%		50% beam angle		10% beam angle			
							50%	30%	50%	30%	50%	30%	65.0°	fc at beam edge	Beam diameter	fc at beam edge	Beam diameter	
0	1218		0° - 30°	1078.8	22.5	1	.48	.46	.47	.45	.45	.44	Mount height	Initial fc at beam center	Beam diameter	fc at beam edge <td>Beam diameter</td> <td>fc at beam edge</td>	Beam diameter	fc at beam edge
5	1270	124	0° - 40°	1639.4	34.2	2	.44	.41	.43	.41	.41	.40	8	40.3	7.0	20.1	11.5	4.0
15	1352	381	0° - 60°	2050.8	42.7	3	.40	.37	.39	.37	.38	.36	10	21.7	9.5	10.8	15.7	2.2
25	1266	575	0° - 90°	2083.8	43.4	4	.37	.34	.36	.34	.35	.33	12	13.5	12.1	6.7	19.9	1.3
35	895	561	90° - 180°	0.0	0.0	5	.34	.31	.33	.31	.32	.30	14	9.2	14.6	4.6	24.1	0.9
45	455	340	0° - 180°	2083.8	*43.4	6	.31	.28	.31	.28	.30	.28	16	6.7	17.2	3.3	28.3	0.7
55	64	72																
65	22	22																
75	8	9																
85	2	2																
90	0																	

PDXFI 2/42TRT 8AR CLRf

(2) CF42DT/E/IN/835, 3200 lumens per lamp, test no. LTL11024

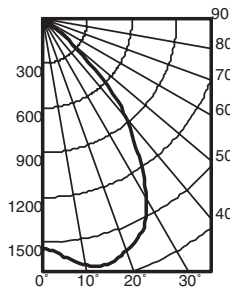

From 0°	Ave	Lumens	Zone	Lumens	% Lamp	pf	Coefficient of Utilization						Illuminance					
							80%		20%		50%		50% beam angle		10% beam angle			
							50%	30%	50%	30%	50%	30%	64.7°	fc at beam edge	Beam diameter	fc at beam edge	Beam diameter	
0	1539		0° - 30°	1350.0	21.1	1	.44	.43	.44	.43	.42	.41	Mount height	Initial fc at beam center	Beam diameter	fc at beam edge <td>Beam diameter</td> <td>fc at beam edge</td>	Beam diameter	fc at beam edge
5	1603	155	0° - 40°	2050.7	32.0	2	.41	.39	.40	.38	.39	.37	8	50.9	7.0	25.4	11.5	5.1
15	1705	478	0° - 60°	2560.1	40.0	3	.37	.35	.37	.35	.36	.34	10	27.4	9.5	13.7	15.7	2.7
25	1577	716	0° - 90°	2599.9	40.6	4	.34	.32	.34	.31	.33	.31	12	17.1	12.0	8.5	19.8	1.7
35	1121	701	90° - 180°	0.0	0.0	5	.32	.29	.31	.29	.30	.28	14	11.6	14.6	5.8	24.0	1.2
45	565	423	0° - 180°	2599.9	*40.6	6	.29	.26	.29	.26	.28	.26	16	8.4	17.1	4.2	28.2	0.8
55	75	86																
65	27	27																
75	10	11																
85	2	2																
90	0																	

PHOTOMETRY NOTES

- Tested to current IES and NEMA standards under stabilized laboratory conditions.
- Actual performance may differ as a result of end-user environment and application.
- Consult factory or IES file for microgroove baffle, black cone or other photometric reports.