



Gotham Architectural Downlighting
Renovation Decorative Compact Fluorescent Downlights

8" PDXFI
Ice™ Color

Horizontal Lamp, Triple-Tube

FEATURES

OPTICAL SYSTEM

- Reflector - Self-flanged, matte diffuse reflector. Fluted vertical upper section works in conjunction with patented Bounding Ray™ Optical Principle design (U.S. Patent No. 5,800,050) to provide lamp before lamp image and smooth transition from top of reflector to bottom.
- Cross Baffle - Red, blue, amber or white acrylic cross baffle, jacketed with aluminum (U.S. Patent No. 6,273,592 B1), provides a vibrant edge-glow color appearance. Available in flush or round (convex) baffle styles.
- Hinged lampdoor provided for optimal fixture efficiency and the reduction of stray light in the plenum.

MECHANICAL

- Pre-wired galvanized steel junction box mounted to reflector provided with removable access cover. No. 12 AWG conductors rated for 90°C.
- Three (3) swinggate brackets allow for installation from below the ceiling. Suitable for ceiling thickness ranging from 5/8" (1.59cm) to 1" (2.54cm).

ELECTRICAL SYSTEM

- Horizontally-mounted, positive-latch, thermoplastic socket(s).
- Thermally protected, high power factor electronic ballast(s) mounted to the junction box.

LISTING

- Fixtures are UL Listed, non-IC recessed mounting and damp locations.

WARRANTY

- 1-year limited warranty. Complete warranty terms located at: www.acuitybrands.com/CustomerResources/Terms_and_conditions.aspx

ORDERING INFORMATION

EXAMPLE: PDXFI 1/32TRT 8AR RLRF MVOLT

Series	Lamp/Wattage	Aperture/Trim color	Baffle type	Voltage	Ballast	Options
PDXFI	1/18TRT	8AR Clear	RLRF Red flush	MVOLT ¹ 120 277	(blank) Electronic ballast	TRW White painted flange WLP With 3500 K lamp (shipped separately) GMF ² Single, slow-blow fuse GLR ² Single, fast-blow fuse GSKT Foam gasketing, ships uninstalled
	1/26TRT		RLRR Red round		ADEZ ² Advance Mark 10® electronic dimming ballast. Minimum dimming level 5%	
	1/32TRT		BLRF Blue flush		ECOS Lutron EcoSystem® electronic dimming ballast. Minimum dimming level 5%.	
	1/42TRT		BLRR Blue round			
	2/18TRT		ALRF Amber flush			
	2/26TRT		ALRR Amber round			
	2/32TRT		WLRF White flush			
	2/42TRT		WLRR White round			

NOTES

ORDERING NOTES

1. Multi-volt electronic ballast capable of operating on any line voltage from 120V through 277V, 50 or 60Hz.
2. Available in 120V or 277V only.

All dimensions are inches (centimeters) unless otherwise noted.

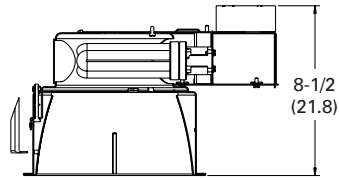
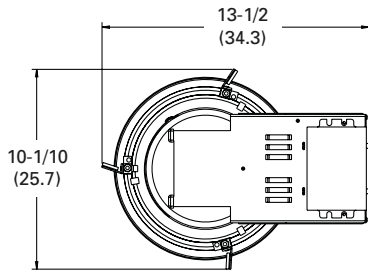

- Aperture: 7-7/8 (20.0)
- Ceiling Opening: 8-5/8 (21.9)
- Overlap Trim: 9-1/4 (23.5)

Distribution Curve Distribution Data Output Data Coefficient of Utilization Illuminance: Single Luminaire 30" Above Floor

PDXFI 2/32TRT 8AR WLRR (2) CF32DT/E/IN/835, 2400 lumens per lamp, Test no. LTL14261X

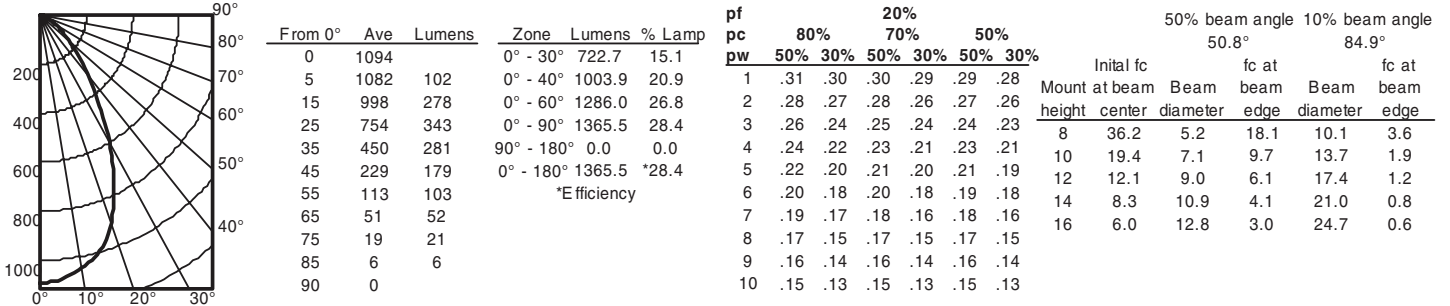

PDXFI 2/32TRT 8AR WLRF (2) CF32DT/E/IN/835, 2400 lumens per lamp, Test no. LTL14262X

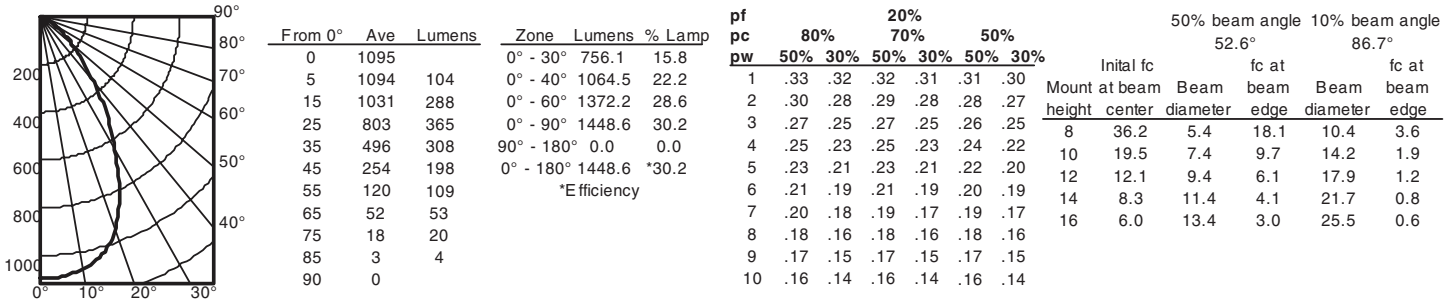

PHOTOMETRY NOTES

- Tested to current IES and NEMA standards under stabilized laboratory conditions.
- Actual performance may differ as a result of end-user environment and application.
- Consult factory or IES file for microgroove baffle, black cone or other photometric reports.