



Gotham Architectural Downlighting
Compact Fluorescent Downlights

6" LGFLP
Non-Conductive Shower Light

Lensed Low Profile
Triple-Tube Lamp

FEATURES

OPTICAL SYSTEM

- Aluminum upper reflector coated with highly reflective white paint provides high efficiency and an evenly illuminated aperture appearance.
- Lens door made of impact-modified acrylic provides excellent durability and light transmission. "Dead front" shower light for added safety.

MECHANICAL SYSTEM

- 16-gauge galvanized steel mounting/plaster frame. Maximum 1-1/4" ceiling thickness.
- 16-gauge galvanized steel mounting bars with continuous 4" vertical adjustment are shipped pre-installed. Post-installation adjustment possible without the use of tools from above or below ceiling.
- Galvanized steel junction box with hinged access covers and spring latch. Two combination 1/2"-3/4" and three 1/2" knockouts for straight-through conduit runs. Capacity: 8 (4 in, 4 out) No. 12 AWG conductors rated for 90°C.
- Low-profile design allows for 4-5/16" fixture depth above ceiling.

ELECTRICAL SYSTEM

- Galvanized steel lampholder housing.
- Horizontally mounted, four-pin, positive-latch, thermoplastic socket(s).
- Class P, thermally protected, high-power-factor electronic ballast(s) mounted to the junction box.

LISTING

- Fixtures are UL Listed for thru-branch wiring, non-IC recessed mounting and wet locations. Listed and labeled to comply with Canadian standards.
- IP65 rated.

WARRANTY

- 1-year limited warranty. Complete warranty terms located at: www.acuitybrands.com/CustomerResources/Terms_and_conditions.aspx

ORDERING INFORMATION

EXAMPLE: LGFLP 1/26TRT 6DFR MVOLT

Series	Wattage/Lamp	Door frame	Voltage	Ballast	Options
LGFLP	1/18TRT	6DFR Dead (non-conductive) front regressed	MVOLT ²	(blank) Electronic ballast	ELR⁵ Emergency battery pack, remote test switch ELRHL⁵ High lumen output emergency battery pack, remote test switch provided GMF³ Single, slow-blow fuse GLR³ Single, fast-blow fuse TRW White painted flange DS Dual switching CP⁶ Chicago plenum WLP With 3500 K lamp (shipped separately) NEPP Interface for Sensor Switch® nLight® network with integral power supply. Refer to TN-623-01 .
	1/26TRT ¹		120	ECOS ³ EcoSystem® electronic dimming ballast. Minimum dimming level 5%	
	1/32TRT	6DFD Dead (non-conductive) front drop	277	ADEZ ^{3,4} Advance Mark 10® electronic dimming ballast. Minimum dimming level 5%	
	1/42TRT		347	ADZT ^{3,4} Advance Mark 7® electronic dimming ballast. Minimum dimming level 5%	

NOTES

ORDERING NOTES

1. Will also operate 26DTT 4-PIN lamp.
2. Multi-volt electronic ballast capable of operating on any voltage from 120V through 277V, 50 or 60 Hz.
3. Not available with 347V.
4. Not available with MVOLT.
5. For dimensional changes, refer to [TECH-140](#).
6. Not available with emergency options.

6" LGFLP

Non-Conductive Shower Light

Lensed Low Profile, Triple-Tube Lamp



DIMENSIONAL DATA

All dimensions are inches (centimeters) unless otherwise noted.

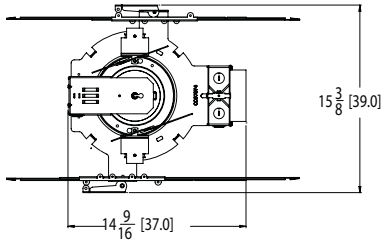

Aperture: 6-1/4 (15.9)
Ceiling Opening: 7-1/8 (18.1)
Overlap Trim: 7-3/4 (19.6)

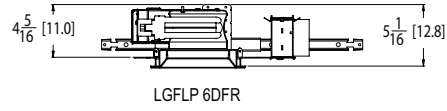

LGFLP 6DFR

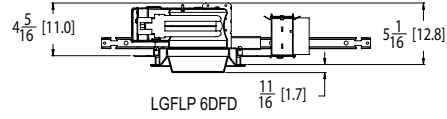

LGFLP 6DFD

Distribution Curve Distribution Data Output Data Coefficient of Utilization Illuminance: Single Luminaire 30" Above Floor

LGFLP 1/32TRT 6DFR

(1) CF32TRT LAMP, 1.2 S/MH, 2400 RATED LUMENS, TEST NO. LTL20099

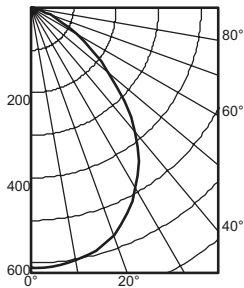

Ave Lumens	Zone	Lumens	% Lamp	pf	pc	pw	80%			70%			50%			
							50%	30%	10%	50%	30%	10%	50%	30%	10%	
0 612	0° - 30°	469.3	19.6	0	62	62	62	61	61	61	58	58	58			
5 610	0° - 40°	743.7	31.0	1	56	54	53	55	53	52	53	51	50			
15 590	0° - 60°	1141.4	47.6	2	50	47	45	49	46	44	47	45	43			
25 534	0° - 90°	1255.3	52.3	3	45	41	38	44	41	38	43	40	37			
35 441	90° - 180°	0.0	0.0	4	40	36	33	40	36	33	39	35	33			
45 311	0° - 180°	1255.3	*52.3	5	37	32	29	36	32	29	35	32	29			
55 176	*Efficiency			6	33	29	26	33	29	26	32	28	26			
65 79				7	30	26	23	30	26	23	29	26	23			
75 27				8	28	24	21	28	24	21	27	23	21			
85 3				9	26	22	19	26	22	19	25	21	19			
90 0				10	24	20	18	24	20	18	23	20	17			

Mounting Height	Initial Center Beam	50% beam - 61.7°		10% beam - 100.7°	
		Diameter	FC	Diameter	FC
8.0	20.2	6.6	10.1	13.3	2.0
10.0	10.9	9.0	5.4	18.1	1.1
12.0	6.8	11.3	3.4	22.9	0.7
14.0	4.6	13.7	2.3	27.8	0.5
16.0	3.4	16.1	1.7	32.6	0.3

LGFLP 1/32TRT 6DFD

(1) CF32TRT LAMP, 1.2 S/MH, 2400 RATED LUMENS, TEST NO. LTL20100

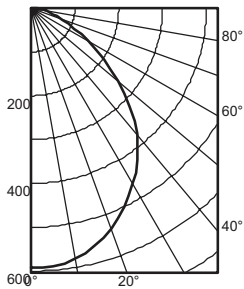

Ave Lumens	Zone	Lumens	% Lamp	pf	pc	pw	80%			70%			50%			
							50%	30%	10%	50%	30%	10%	50%	30%	10%	
0 593	0° - 30°	444.5	18.5	0	66	66	66	64	64	64	61	61	61			
5 591	0° - 40°	708.7	29.5	1	58	56	54	57	55	53	55	53	52			
15 561	0° - 60°	1134.3	47.3	2	51	48	45	50	47	45	49	46	44			
25 501	0° - 90°	1322.7	55.1	3	46	42	38	45	41	38	43	40	37			
35 424	90° - 180°	0.0	0.0	4	41	37	33	40	36	33	39	35	32			
45 319	0° - 180°	1322.7	*55.1	5	37	32	29	36	32	29	35	31	29			
55 201	*Efficiency			6	34	29	26	33	29	25	32	28	25			
65 109				7	31	26	23	30	26	23	29	25	23			
75 53				8	28	24	21	28	23	20	27	23	20			
85 21				9	26	22	19	26	21	19	25	21	18			
90 0				10	24	20	17	24	20	17	23	19	17			

Mounting Height	Initial Center Beam	50% beam - 60.7°		10% beam - 102.6°	
		Diameter	FC	Diameter	FC
8.0	19.6	6.4	9.8	13.7	2.0
10.0	10.5	8.8	5.3	18.7	1.1
12.0	6.6	11.1	3.3	23.7	0.7
14.0	4.5	13.5	2.2	28.7	0.4
16.0	3.3	15.8	1.6	33.7	0.3

LGFLP 1/26TRT 6DFR

(1) CF26TRT LAMP, 1.2 S/MH, 1800 RATED LUMENS, TEST NO. LTL20101

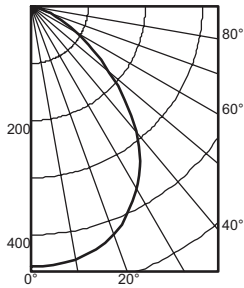

Ave Lumens	Zone	Lumens	% Lamp	pf	pc	pw	80%			70%			50%			
							50%	30%	10%	50%	30%	10%	50%	30%	10%	
0 456	0° - 30°	351.1	19.5	0	62	62	62	61	61	61	58	58	58			
5 455	0° - 40°	557.4	31.0	1	56	54	53	55	53	52	53	51	50			
15 440	0° - 60°	854.7	47.5	2	50	47	45	49	46	44	47	45	43			
25 400	0° - 90°	940.6	52.3	3	45	41	38	44	41	38	43	40	37			
35 332	90° - 180°	0.0	0.0	4	40	36	33	40	36	33	38	35	33			
45 233	0° - 180°	940.6	*52.3	5	37	32	29	36	32	29	35	32	29			
55 132	*Efficiency			6	33	29	26	33	29	26	32	28	26			
65 59				7	30	26	23	30	26	23	29	26	23			
75 20				8	28	24	21	28	24	21	27	23	21			
85 3				9	26	22	19	25	22	19	25	21	19			
90 0				10	24	20	18	24	20	17	23	20	17			

Mounting Height	Initial Center Beam	50% beam - 62.0°		10% beam - 100.7°	
		Diameter	FC	Diameter	FC
8.0	15.1	6.6	7.5	13.3	1.5
10.0	8.1	9.0	4.1	18.1	0.8
12.0	5.1	11.4	2.5	22.9	0.5
14.0	3.4	13.8	1.7	27.8	0.3
16.0	2.5	16.2	1.3	32.6	0.3

LGFLP 1/26TRT 6DFD

(1) CF26TRT LAMP, 1.2 S/MH, 1800 RATED LUMENS, TEST NO. LTL20102

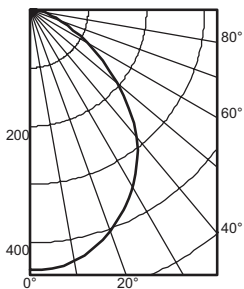

Ave Lumens	Zone	Lumens	% Lamp	pf	pc	pw	80%			70%			50%			
							50%	30%	10%	50%	30%	10%	50%	30%	10%	
0 447	0° - 30°	335.6	18.6	0	66	66	66	64	64	64	62	62	62			
5 445	0° - 40°	535.3	29.7	1	59	56	54	57	55	54	55	53	52			
15 424	0° - 60°	856.6	47.6	2	52	48	46	51	48	45	49	46	44			
25 378	0° - 90°	998.1	55.5	3	46	42	39	45	41	38	44	40	38			
35 320	90° - 180°	0.0	0.0	4	41	37	33	41	36	33	39	36	33			
45 241	0° - 180°	998.1	*55.5	5	37	33	29	37	32	29	35	32	29			
55 151	*Efficiency			6	34	29	26	33	29	26	32	28	25			
65 82				7	31	26	23	30	26	23	29	26	23			
75 40				8	28	24	21	28	24	21	27	23	21			
85 15				9	26	22	19	26	22	19	25	21	19			
90 0				10	24	20	17	24	20	17	23	20	17			

Mounting Height	Initial Center Beam	50% beam - 60.8°		10% beam - 102.6°	
		Diameter	FC	Diameter	FC
8.0	14.8	6.5	7.4	13.7	1.5
10.0	7.9	8.8	4.0	18.7	0.8
12.0	5.0	11.1	2.5	23.7	0.5
14.0	3.4	13.5	1.7	28.7	0.3
16.0	2.5	15.8	1.2	33.7	0.2

PHOTOMETRY NOTES

- Tested to current IES and NEMA standards under stabilized laboratory conditions.
- Actual performance may differ as a result of end-user environment and application.
- Consult factory or IES file for microgroove baffle, black cone or other photometric reports.